

**LAS PRIMERAS**  
**MANIFESTACIONES Y EL**  
**INFLUJO CISTERCIENSE**

Vallbona

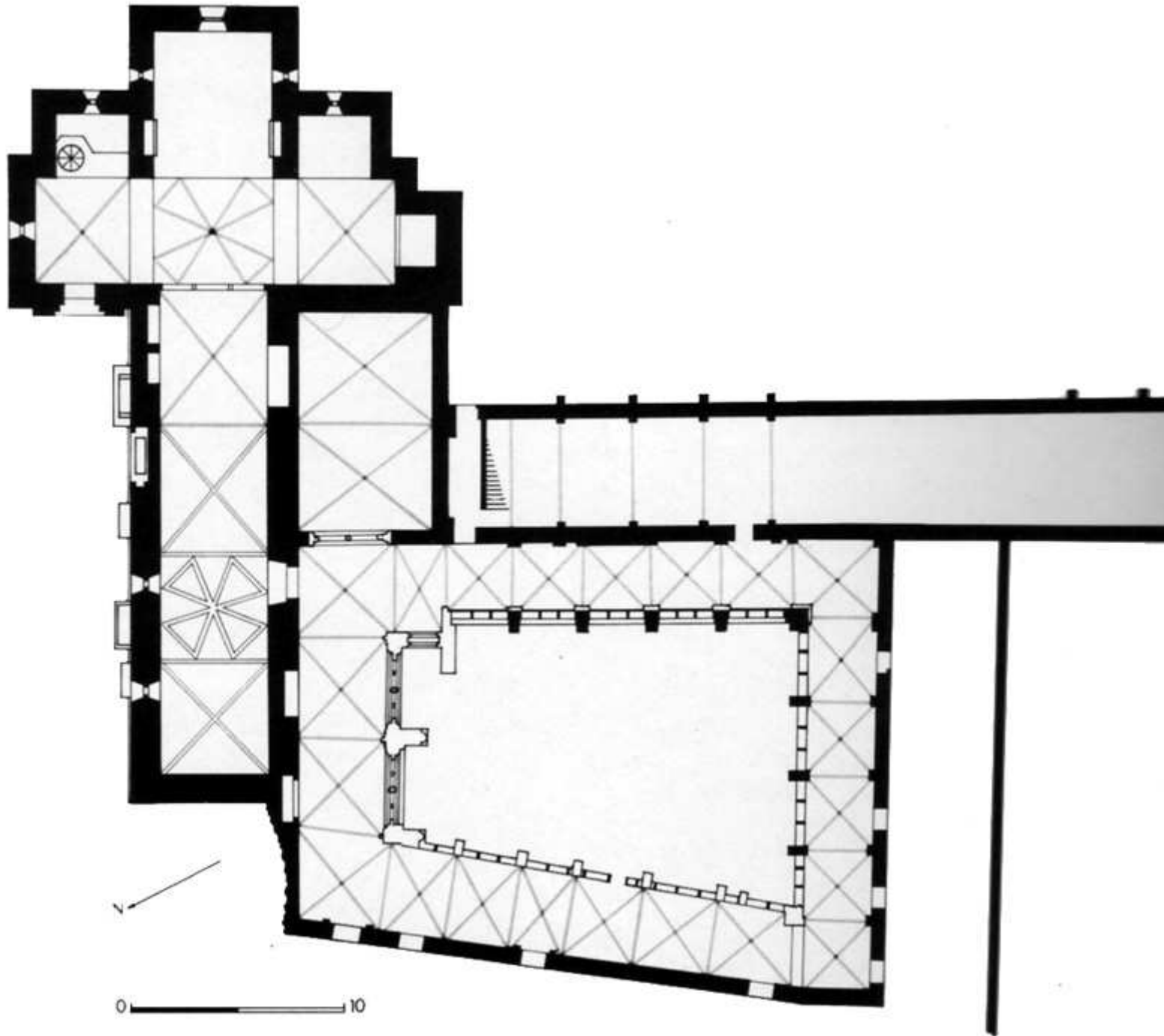

# Santes Creus

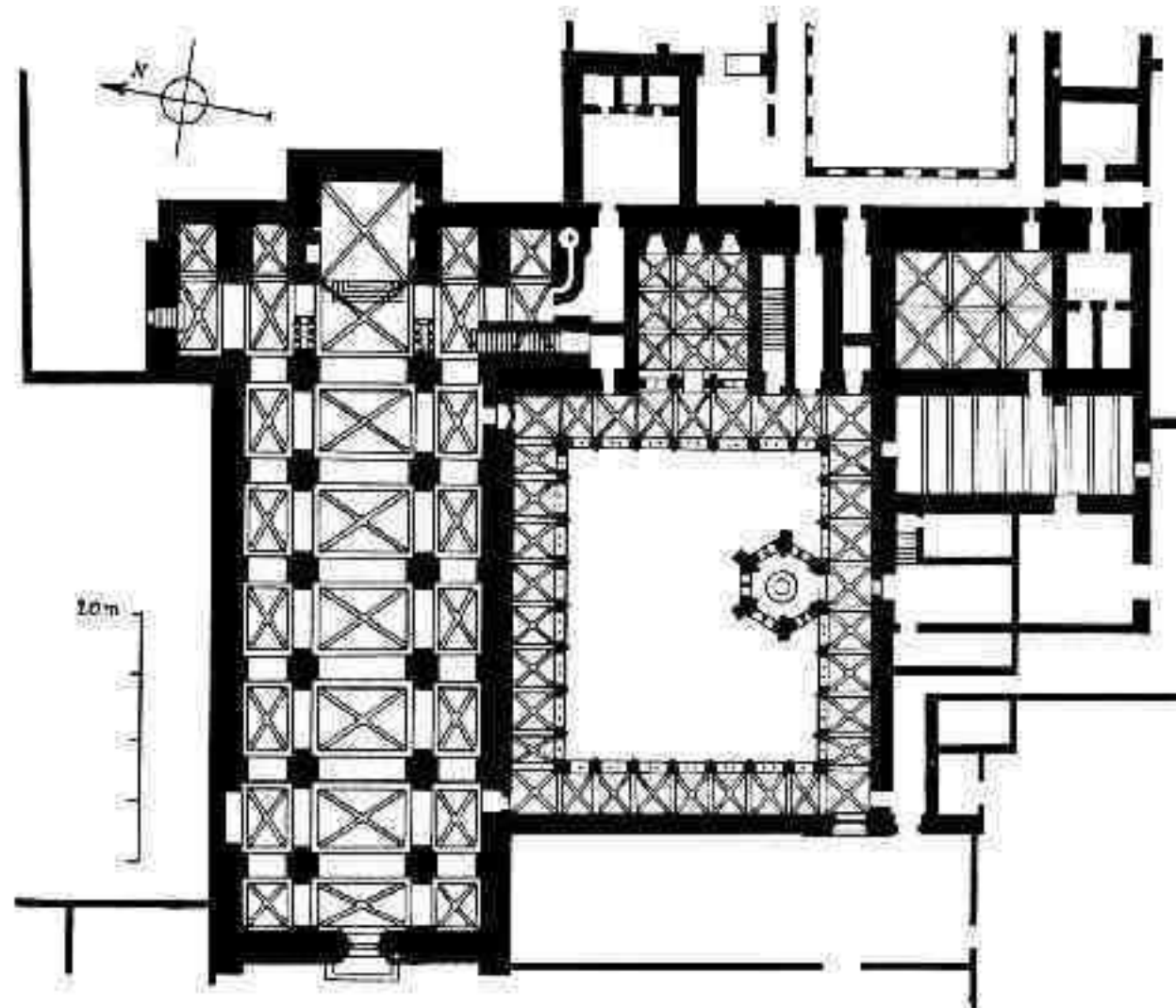

POBLET

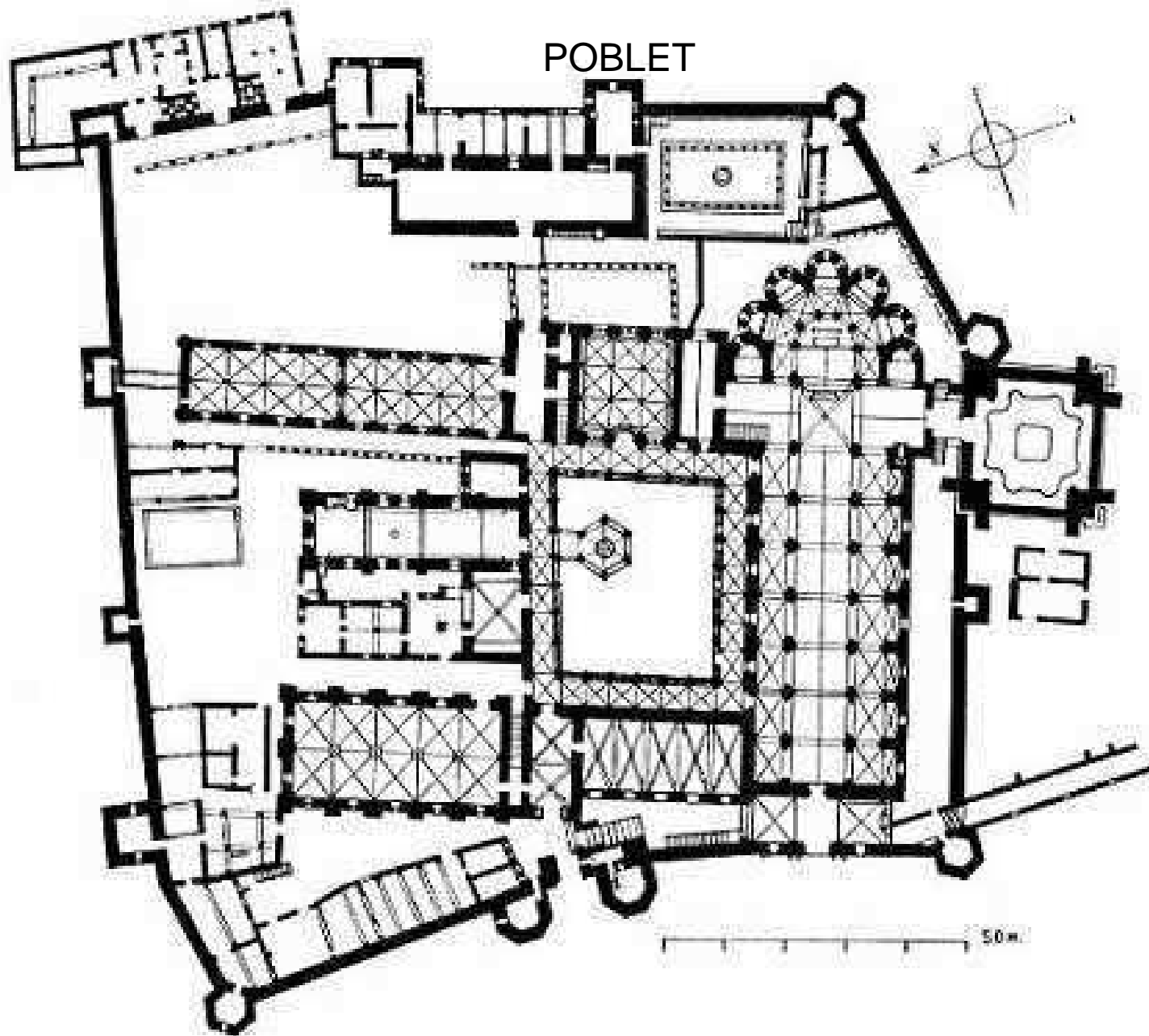

Lérida





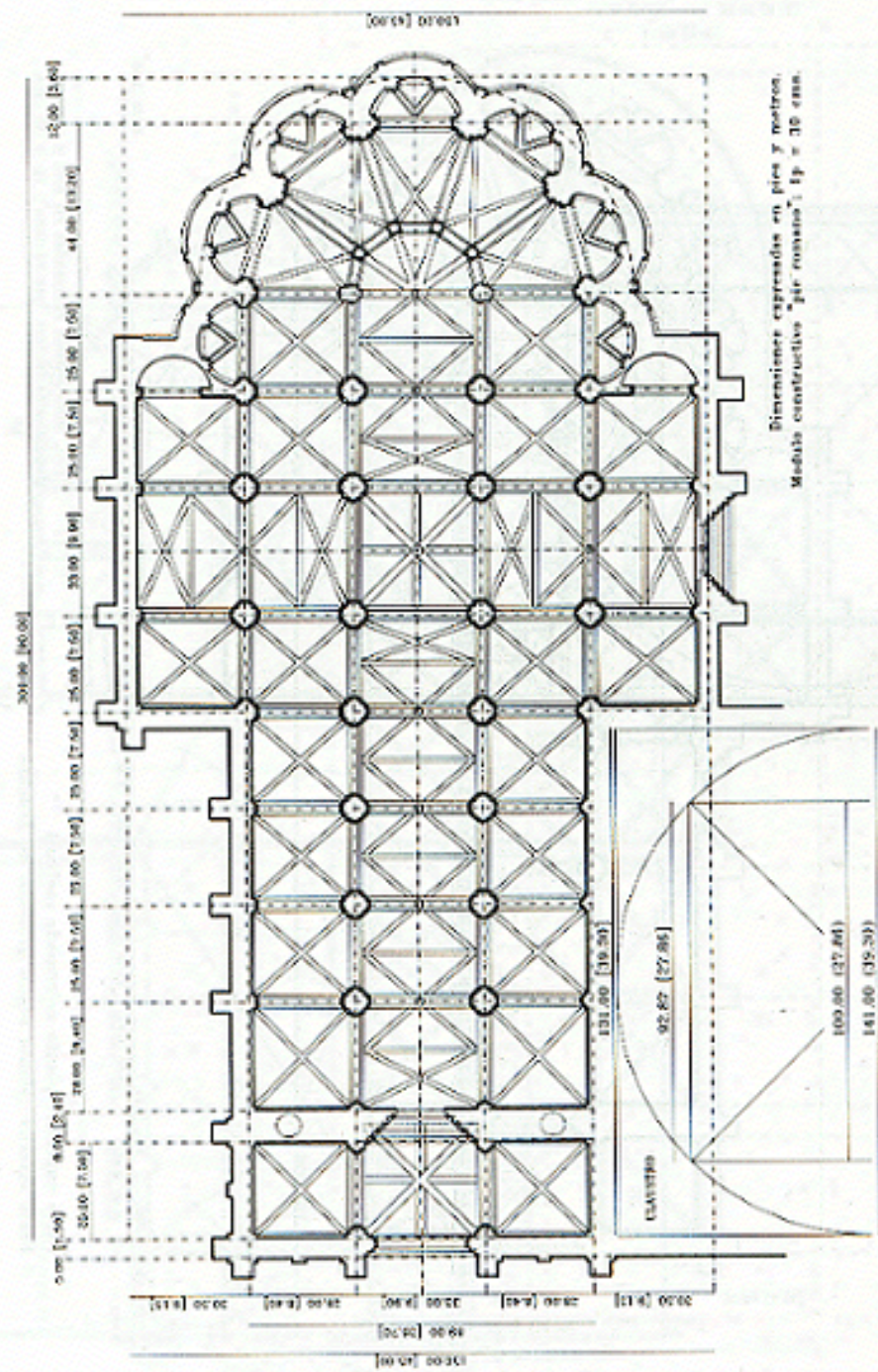

Dimensiones expresadas en pies y metros.  
Módulo constructivo "por cometas" 1p x 30 cms.

Valores del clerestrio segun el motivo "por escallano" de 27.86 cms.

AVILA  
RECONSTRUCCION HIPOTETICA DE LA CATEDRAL  
PLANTA DE BOVEDAS SEGUN PROYECTO DE FRUCHEL

Cuenca

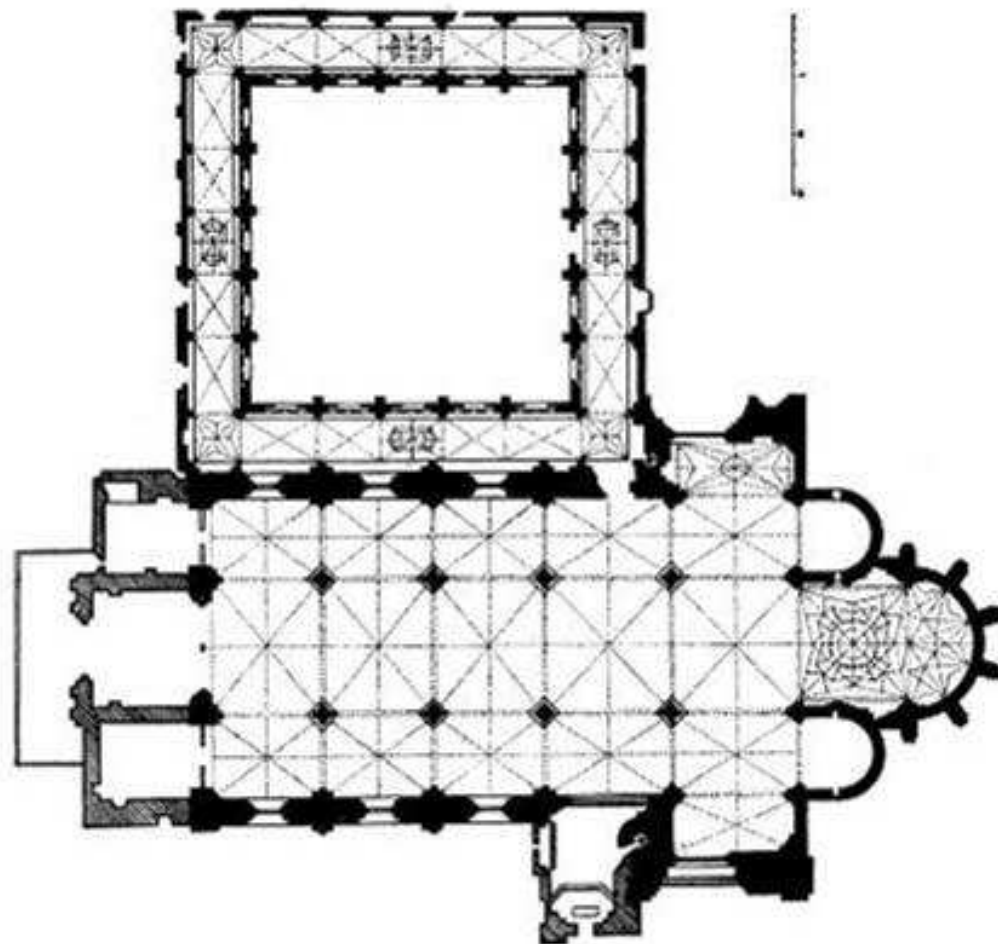



# **EL GÓTICO PLENO**

**EN EL REINADO DE**  
**FERNANDO III**

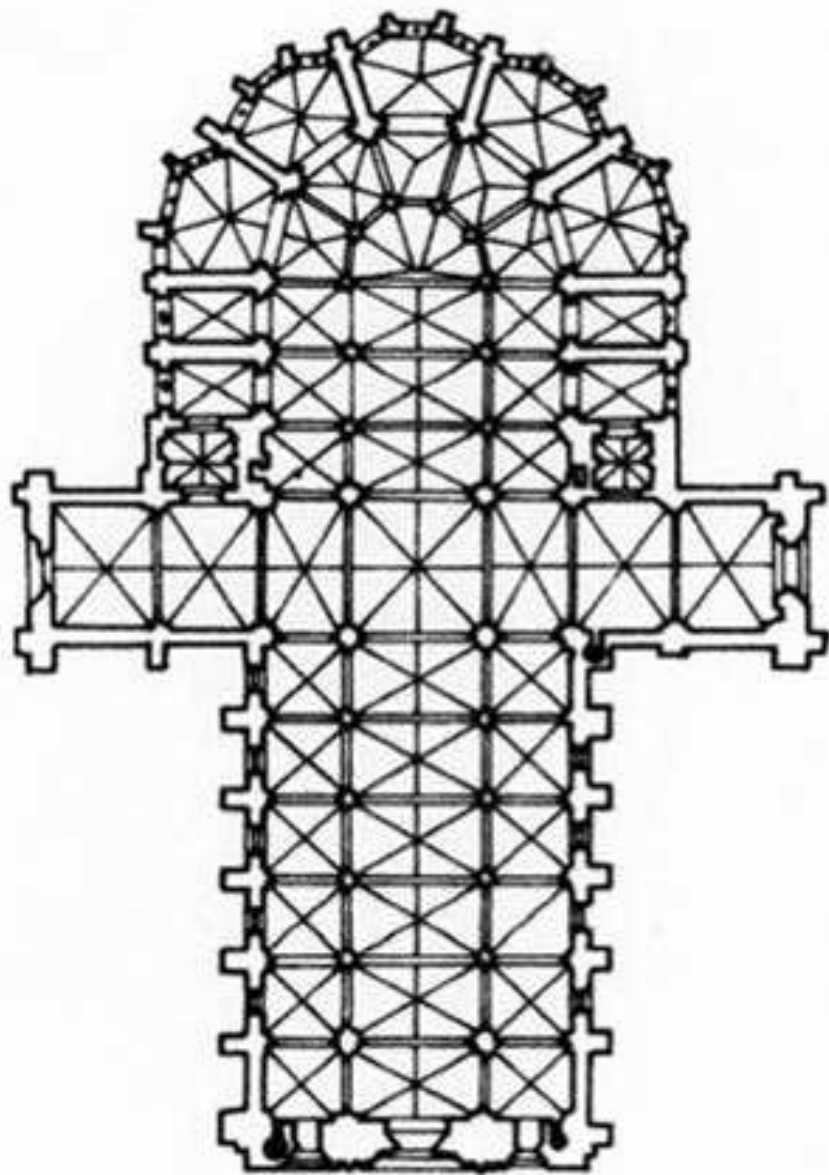

Planta de la catedral de Burgos (España), a partir de 1222.

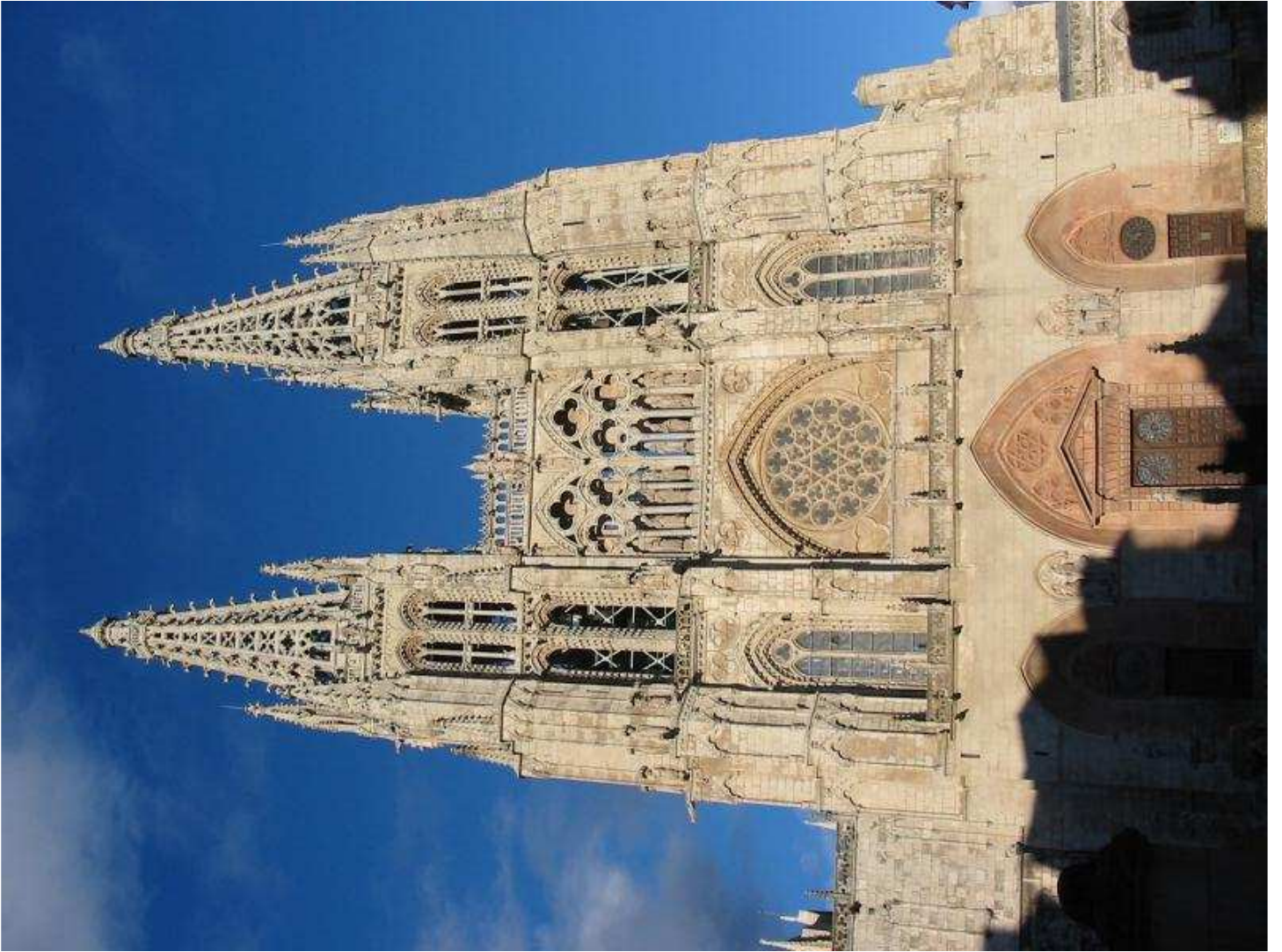

León

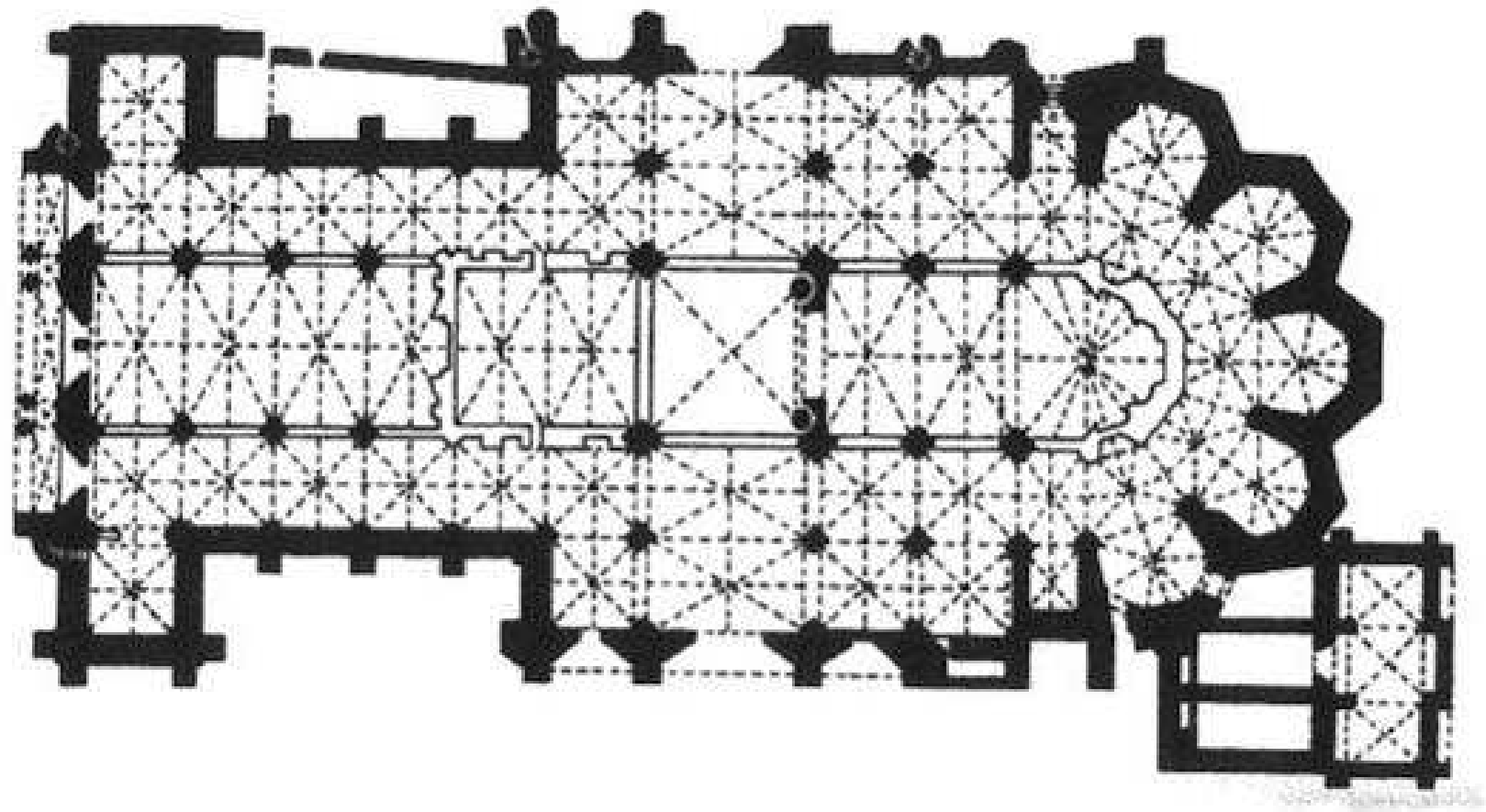

# CATEDRAL DE LEON

Estudio de Arquitectura: ANGEL SANZ RUEDA  
Dibujo.- ANGEL MARTIN CHAVES

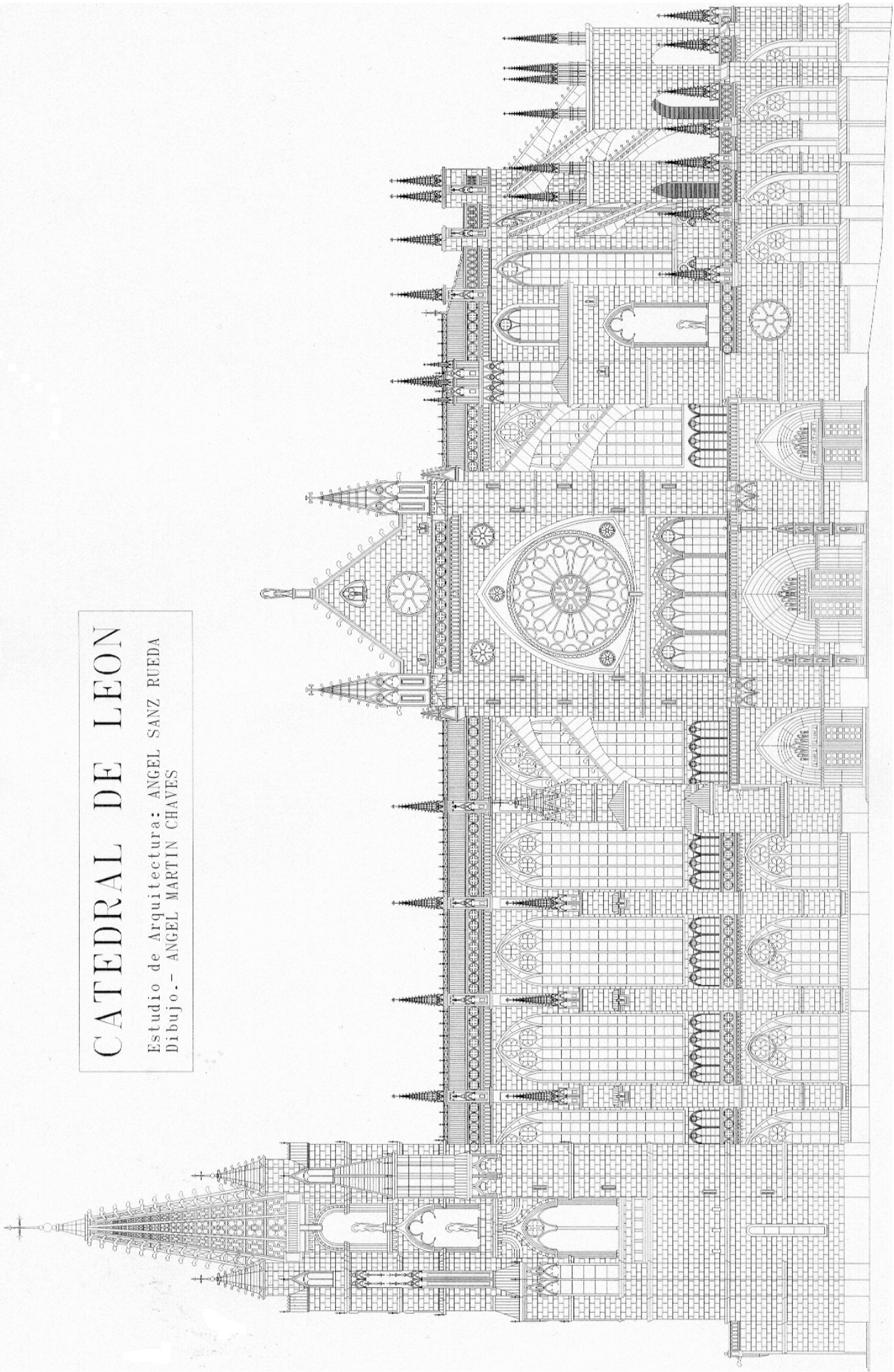





# CATEDRAL DE TOLEDO

0 5 10 20 30 40 50 Metros

Calle de la Tripetría

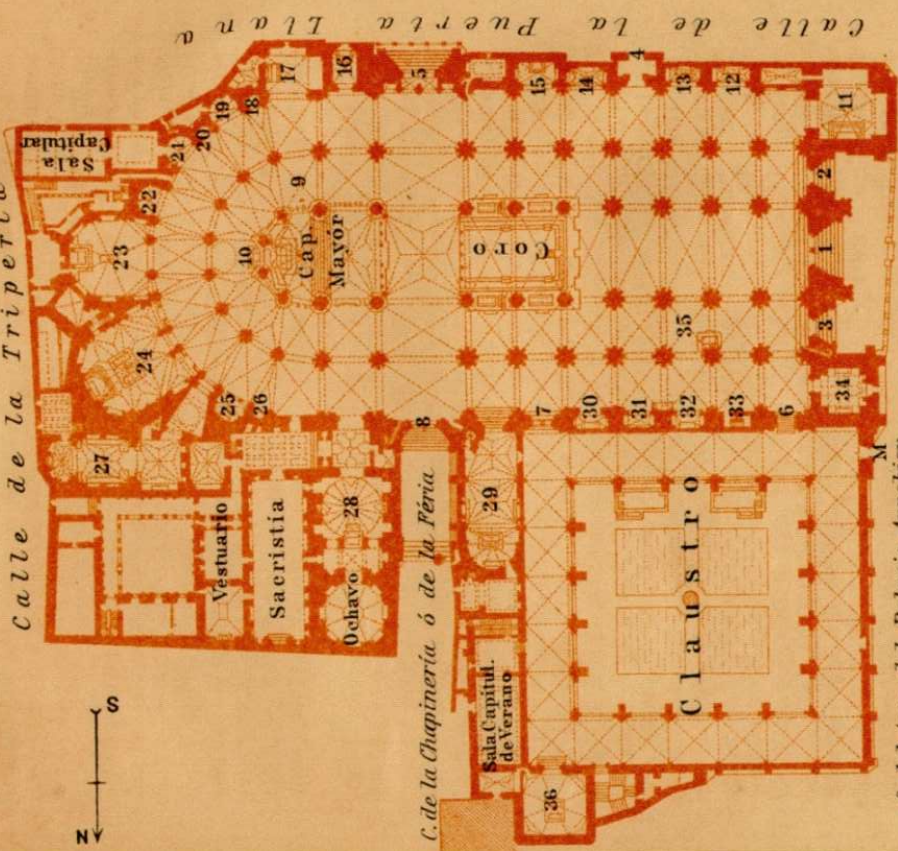

C. del Arco del Palacio Arzobisp. Pl. de Ayuntamiento

- |                                       |                                 |                                    |
|---------------------------------------|---------------------------------|------------------------------------|
| 1 Puerta del Perdón                   | 14 Capilla de San Martín        | 27 Capilla de Reyes nuevos         |
| 2 " de los Escribanos                 | 15 " de San Eugenio             | 28 " de la Virgen d. Sagrario      |
| 3 " de la Torre                       | 16 " de S <sup>a</sup> Lucia    | 29 " de San Pedro                  |
| 4 " de Llerana                        | 17 " de Reyes viejos            | 30 " d. l. Virgen d. l. Piedad     |
| 5 " de los Leones                     | 18 " de S <sup>a</sup> Ana      | 31 " d. l. Pila Bautismal          |
| 6 " de la Presentación                | 19 " de S. I. Bautista          | 32 " d. N. Señora d. l. Antigua    |
| 7 " de S <sup>a</sup> Catalina        | 20 " de San Gil                 | 33 " de Teresa de Hero             |
| 8 " del Reloj                         | 21 " de San Nicolás             | 34 " de San Juan                   |
| 9 Capilla del S <sup>o</sup> Sepulcro | 22 " de la Trinidad             | 35 " d. l. Descension d. N. Señora |
| 10 Transparente                       | 23 " de Santiago                | 36 " de San Blas                   |
| 11 Capilla Mozárabe                   | 24 " de S <sup>a</sup> Leocadia | M Puerta del Mollete               |
| 12 " de la Epifanía                   | 25 " del Cristo d. l. Col.      |                                    |
| 13 " de la Concepción                 |                                 |                                    |



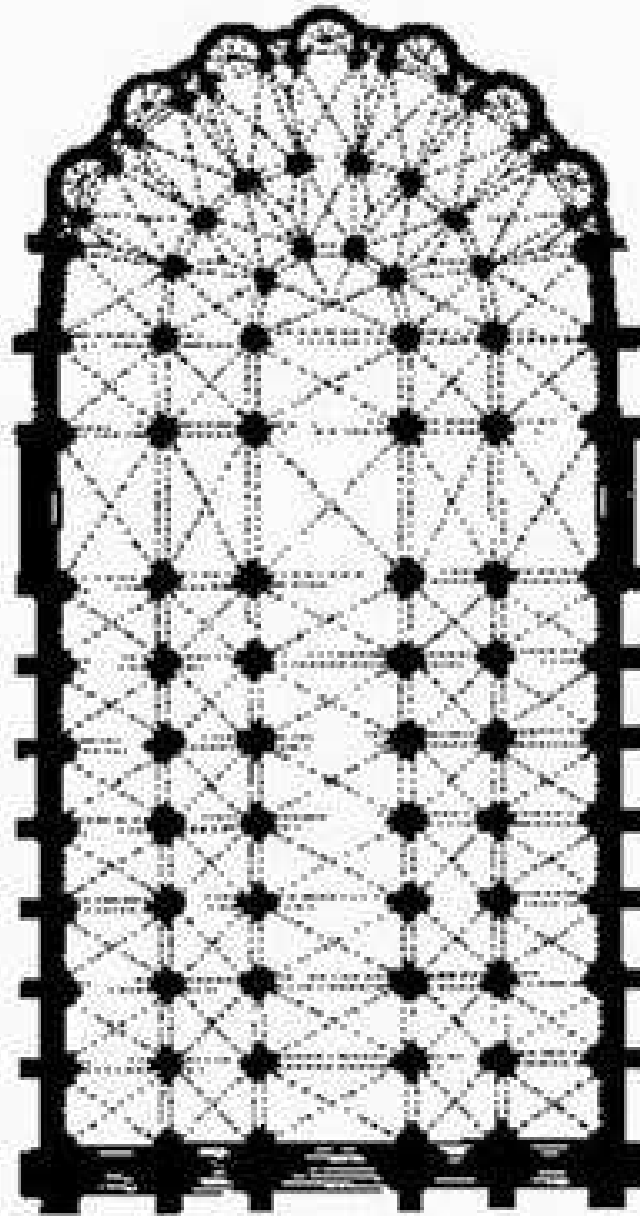

*Planta de la catedral;*  
*s. XIII.*  
*Toledo.*

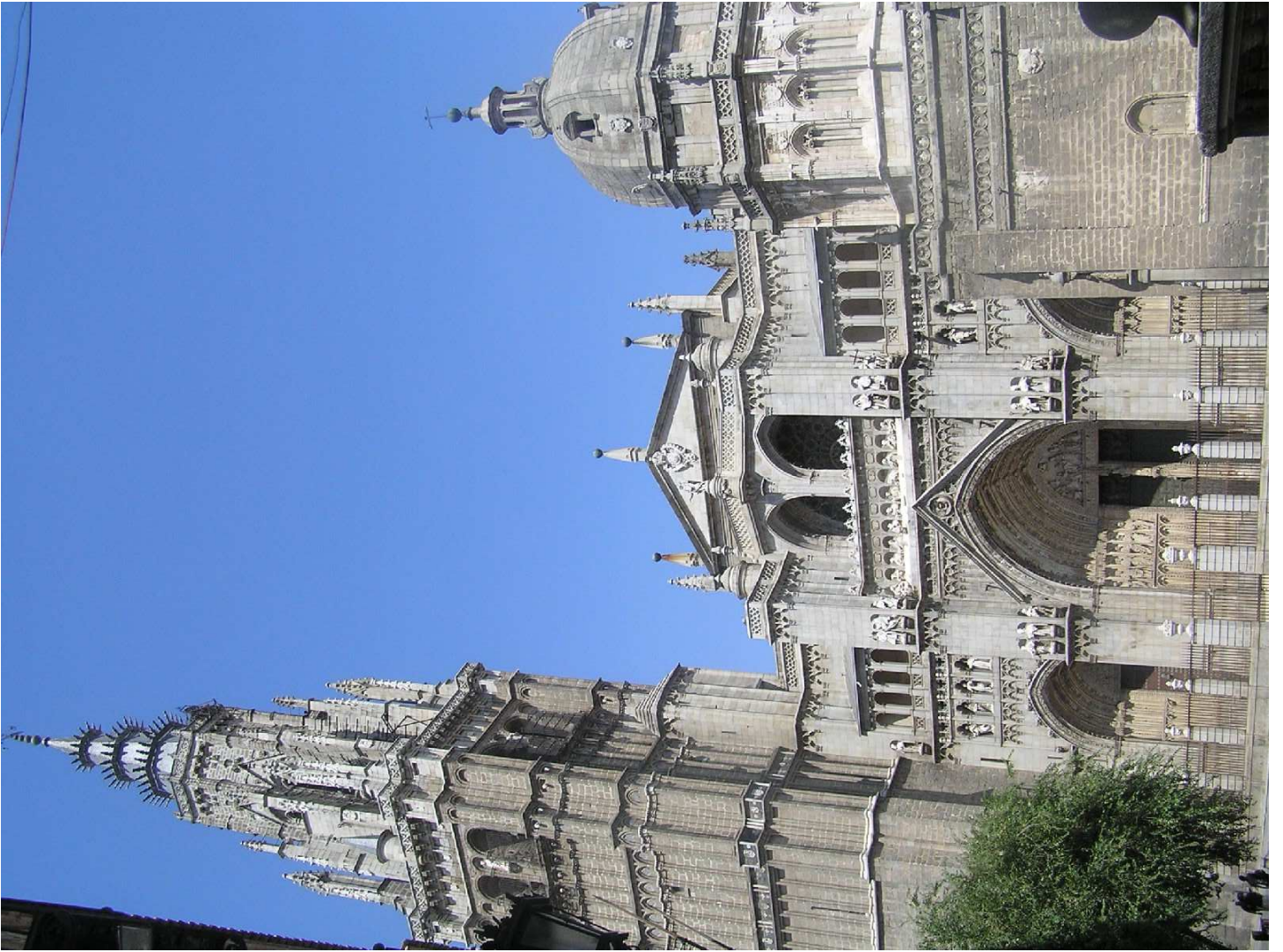



# EL GÓTICO CATALÁN

SIGLO XIV

# BARCELONA







# PALMA DE MALLORCA





# GERONA

Planta de la Seu de Girona 1312...

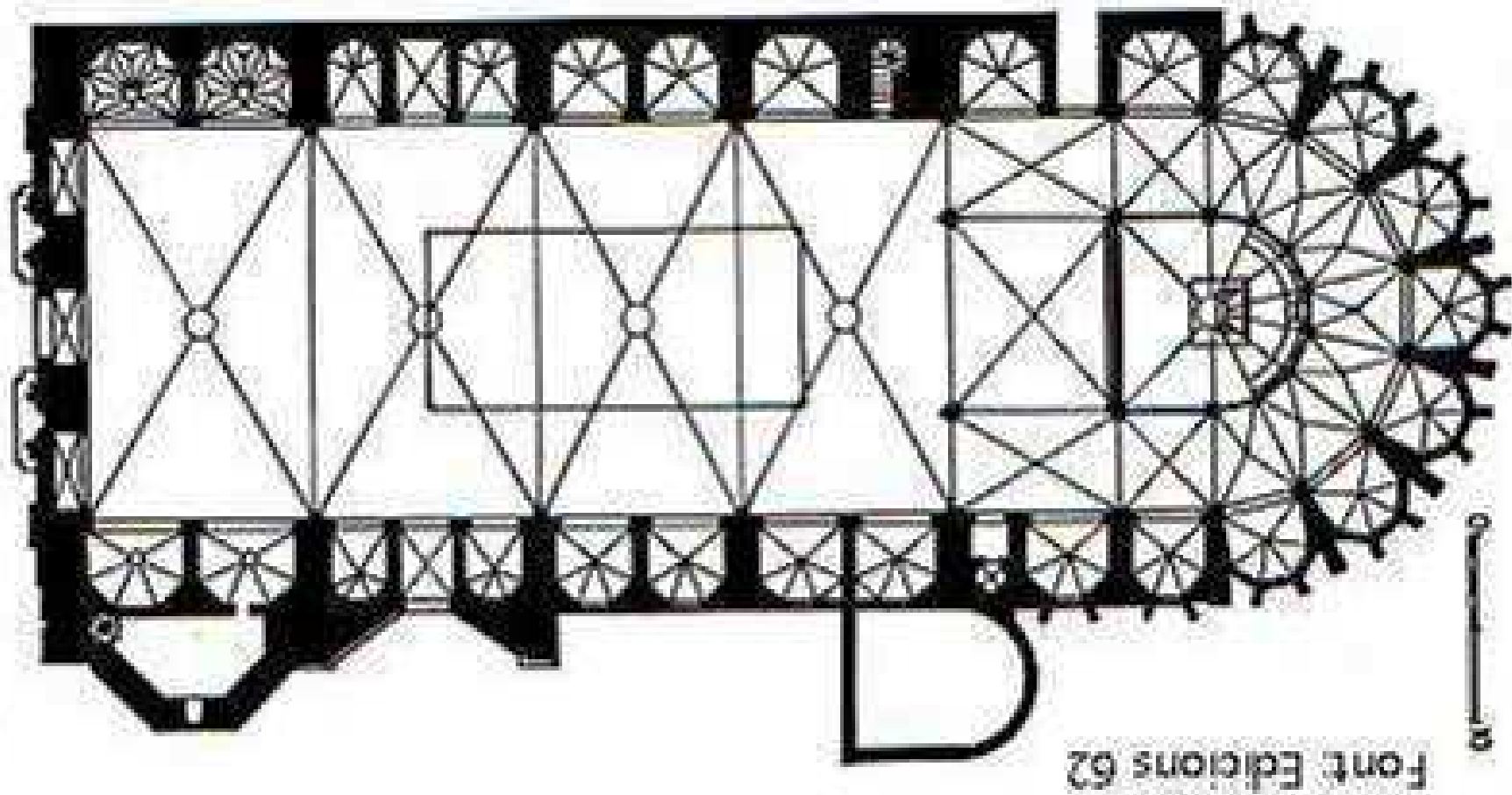

# Manresa

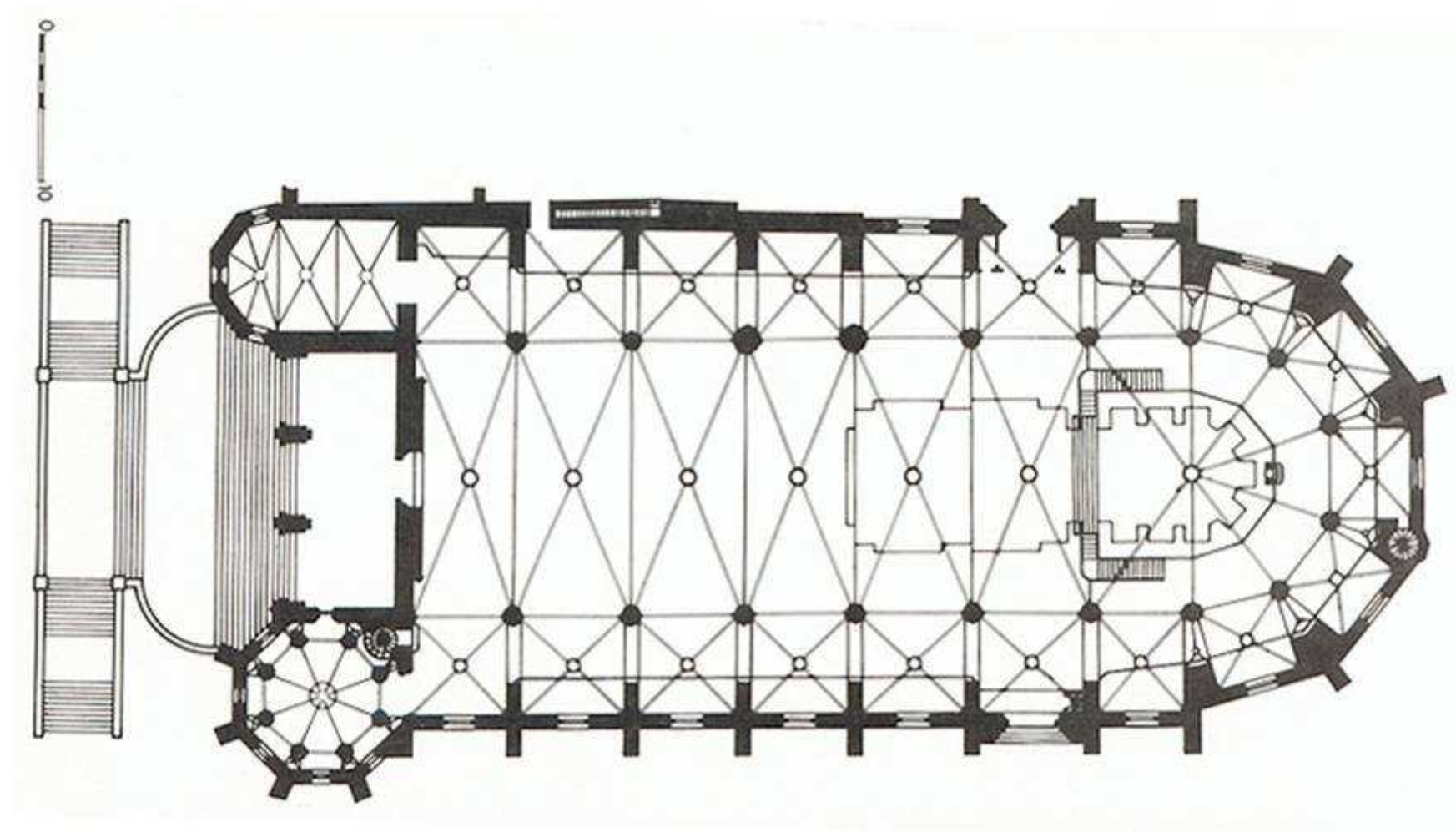



# STA. M<sup>a</sup> DEL MAR

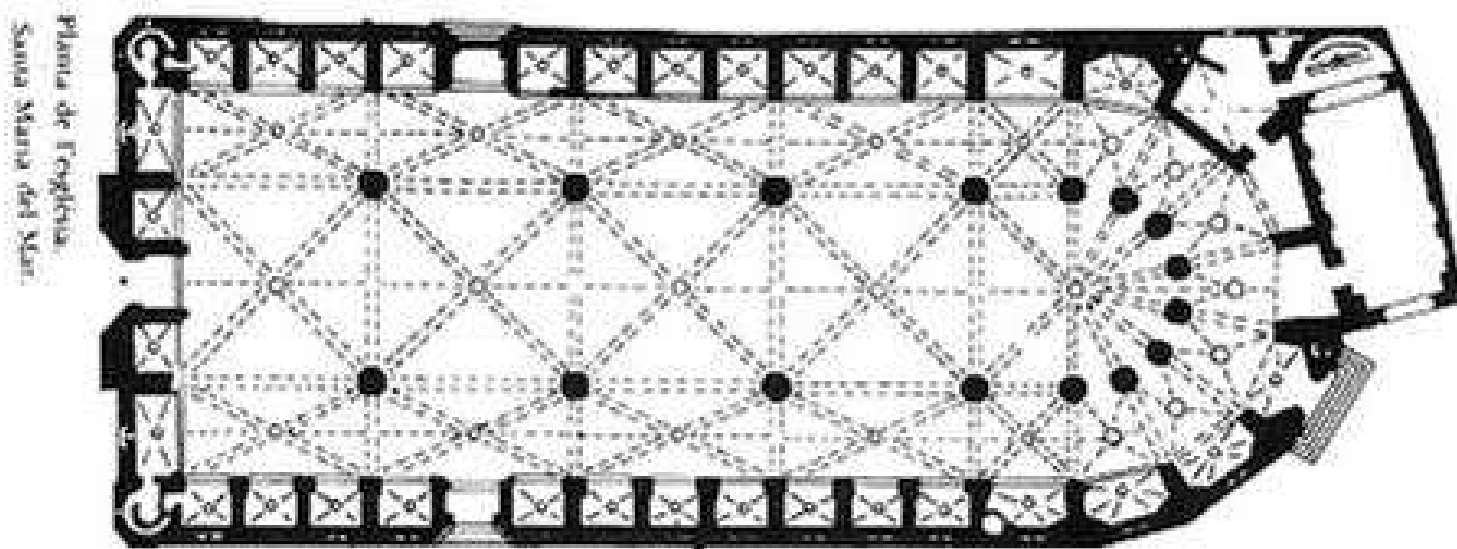



# PALACIO REAL

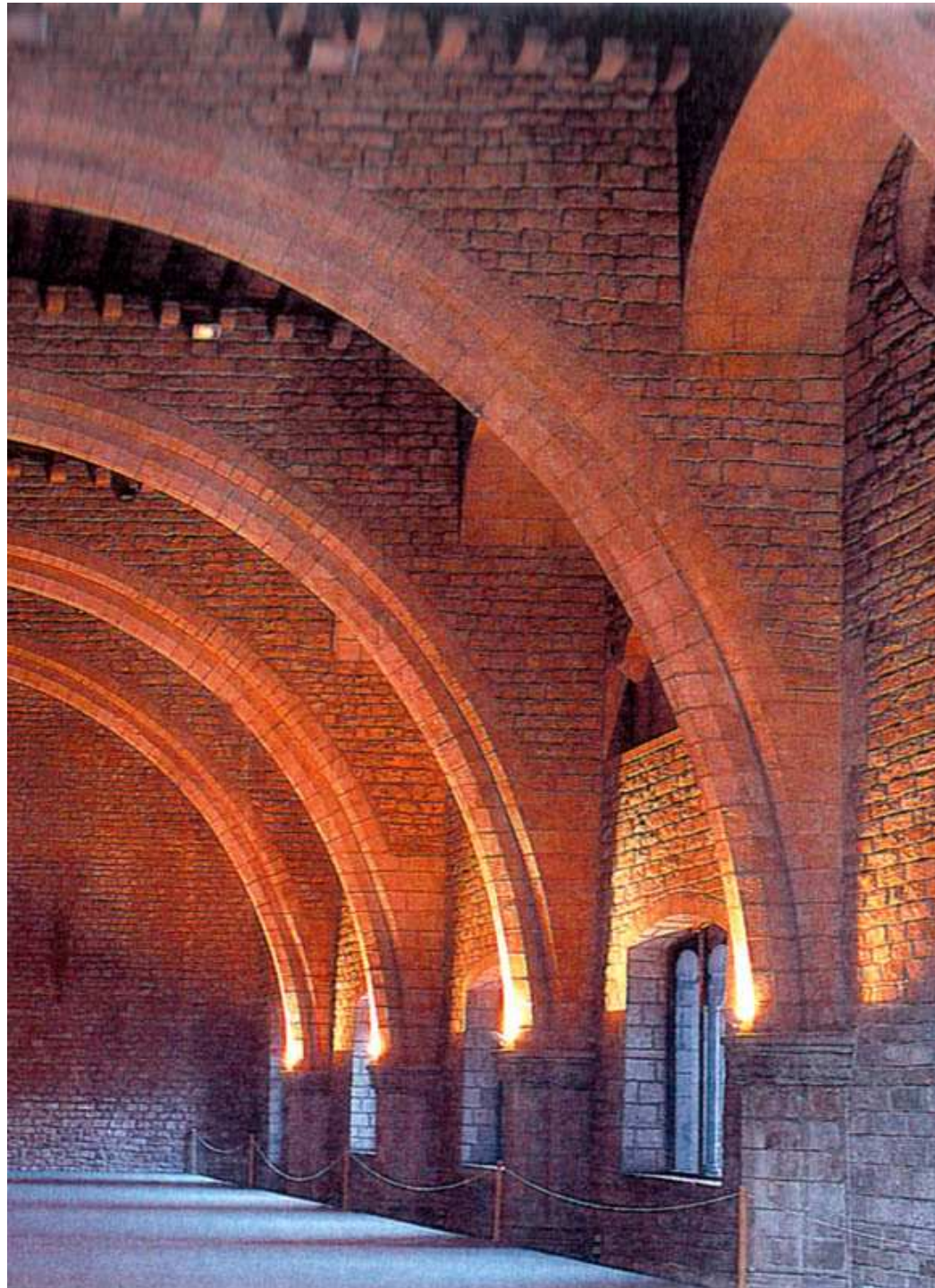

# LONJA DE VALENCIA

*Planta, secció i alçat de  
la Llotja de València  
(segons José Amador de  
los Ríos, 1876).*

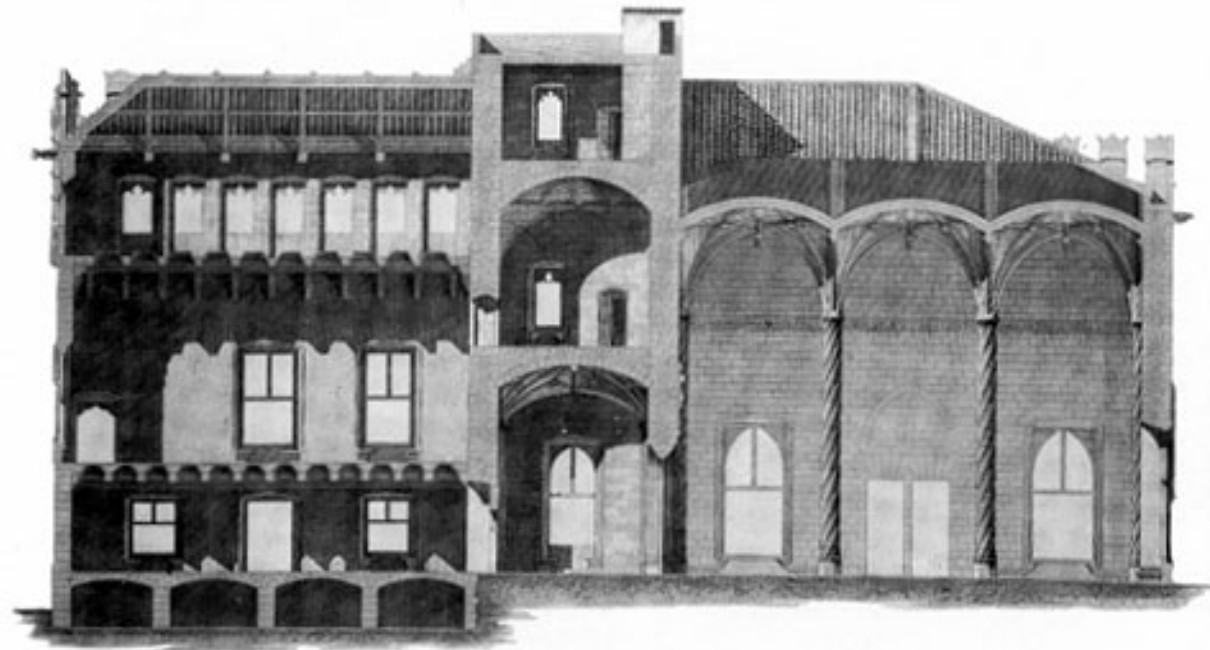
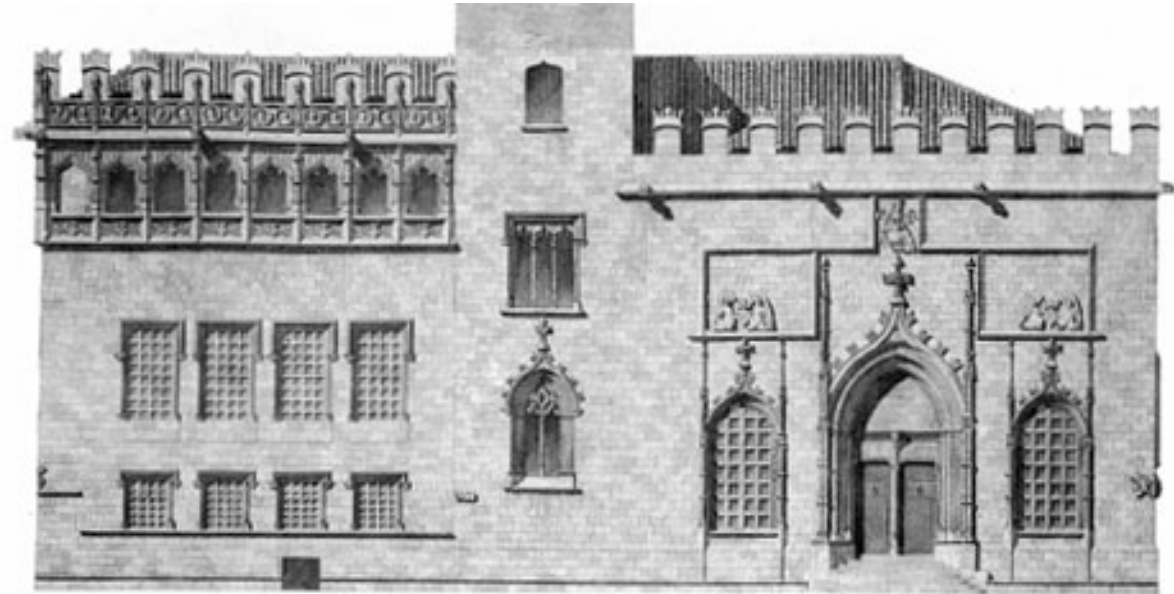
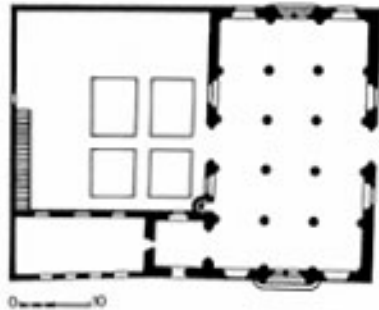

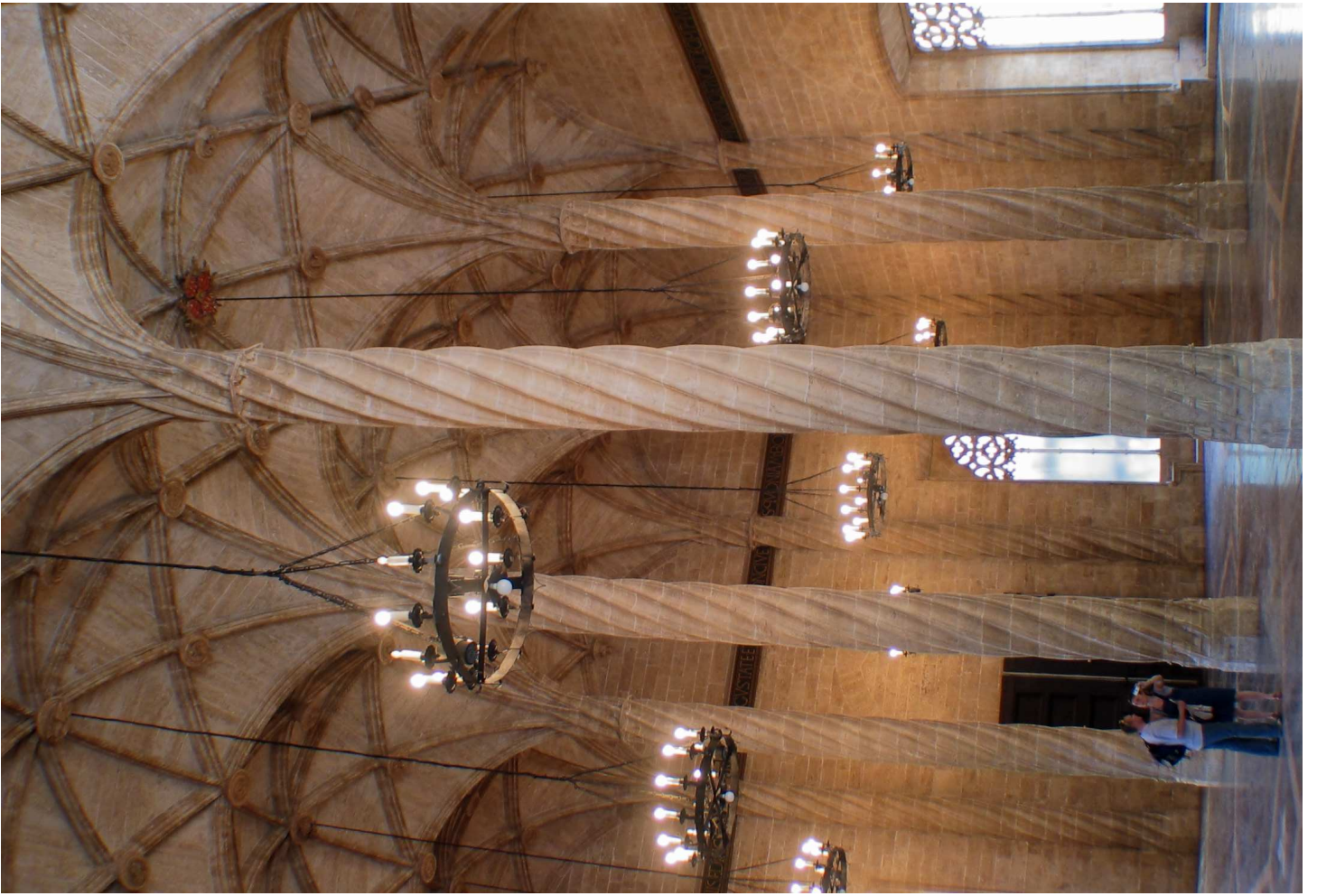





# EL GÓTICO TARDÍO

SIGLOS XV Y XVI

# MULTIPLICACIÓN DE LAS FORMAS DE ARCOS

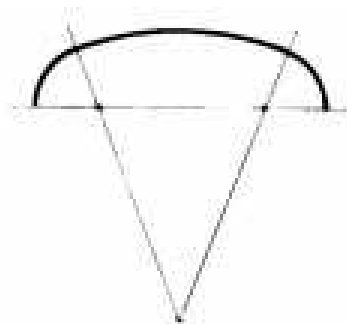

Fig. 95  
Apainelado o carpanel de tres centros.

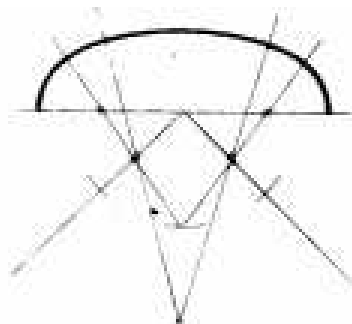

Fig. 96  
Apainelado o carpanel de cinco centros.

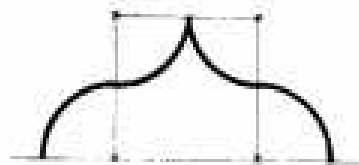

Fig. 97  
Conoidal.

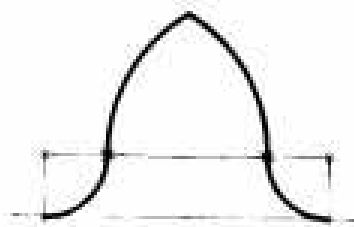

Fig. 98  
En gótico.

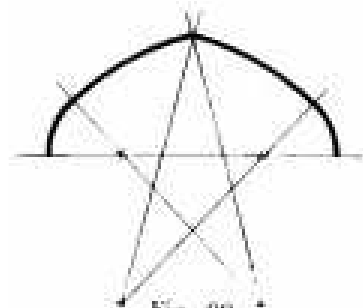

Fig. 99  
Apainelado apuntado o tudor.

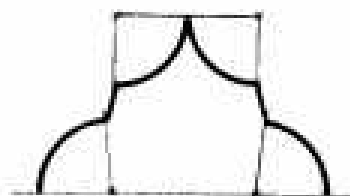

Fig. 100  
Mixtilíneo.



Fig. 101

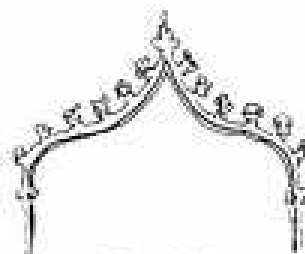

Fig. 102  
Conoidal.

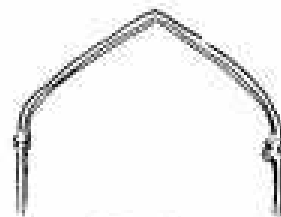

Fig. 104  
Apainelado apuntado.

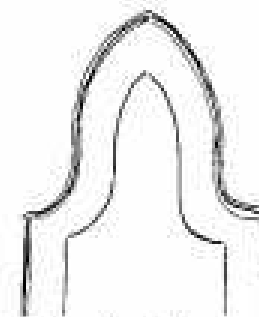

Fig. 103  
En gótico.

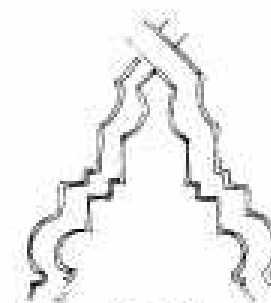
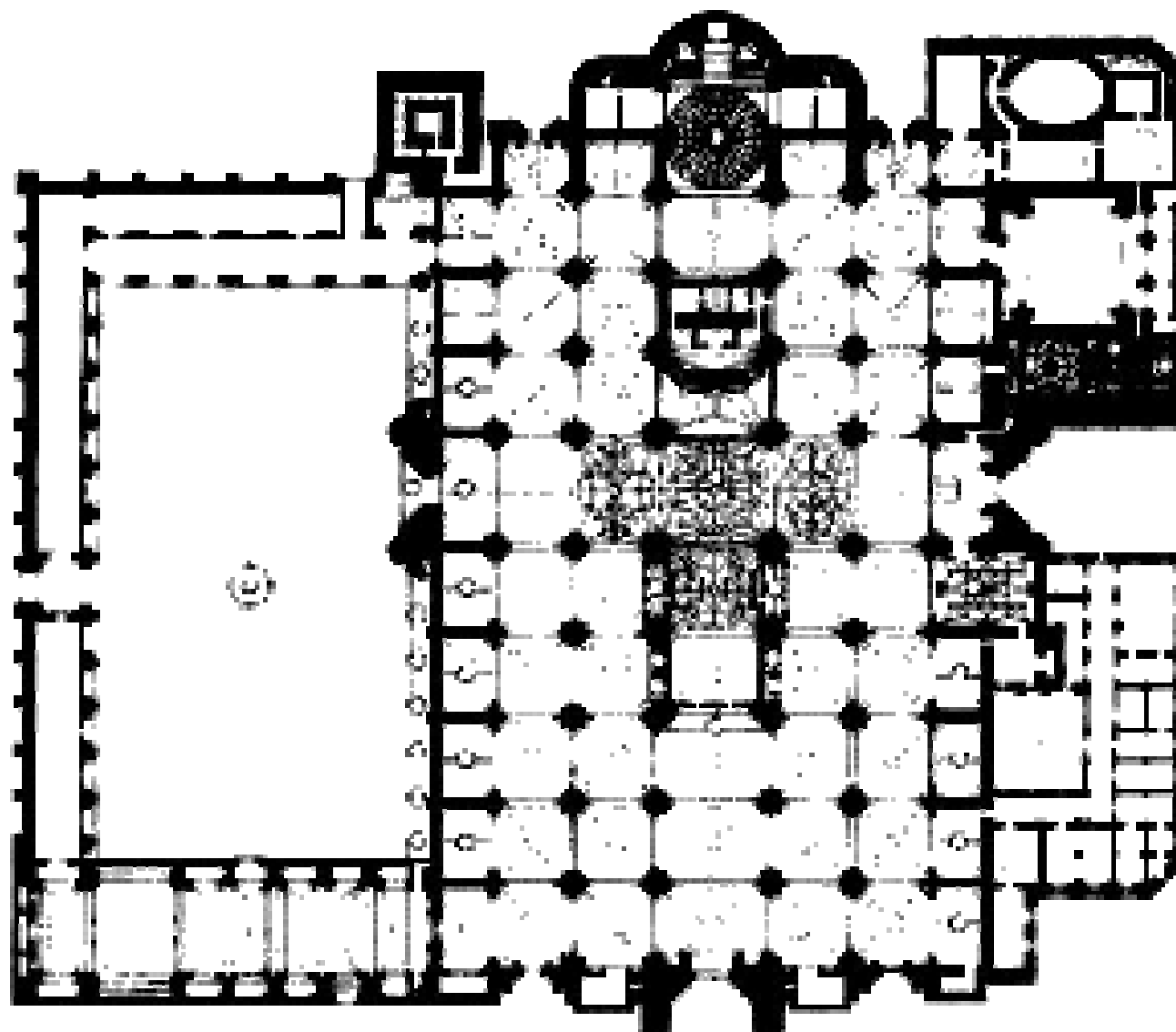
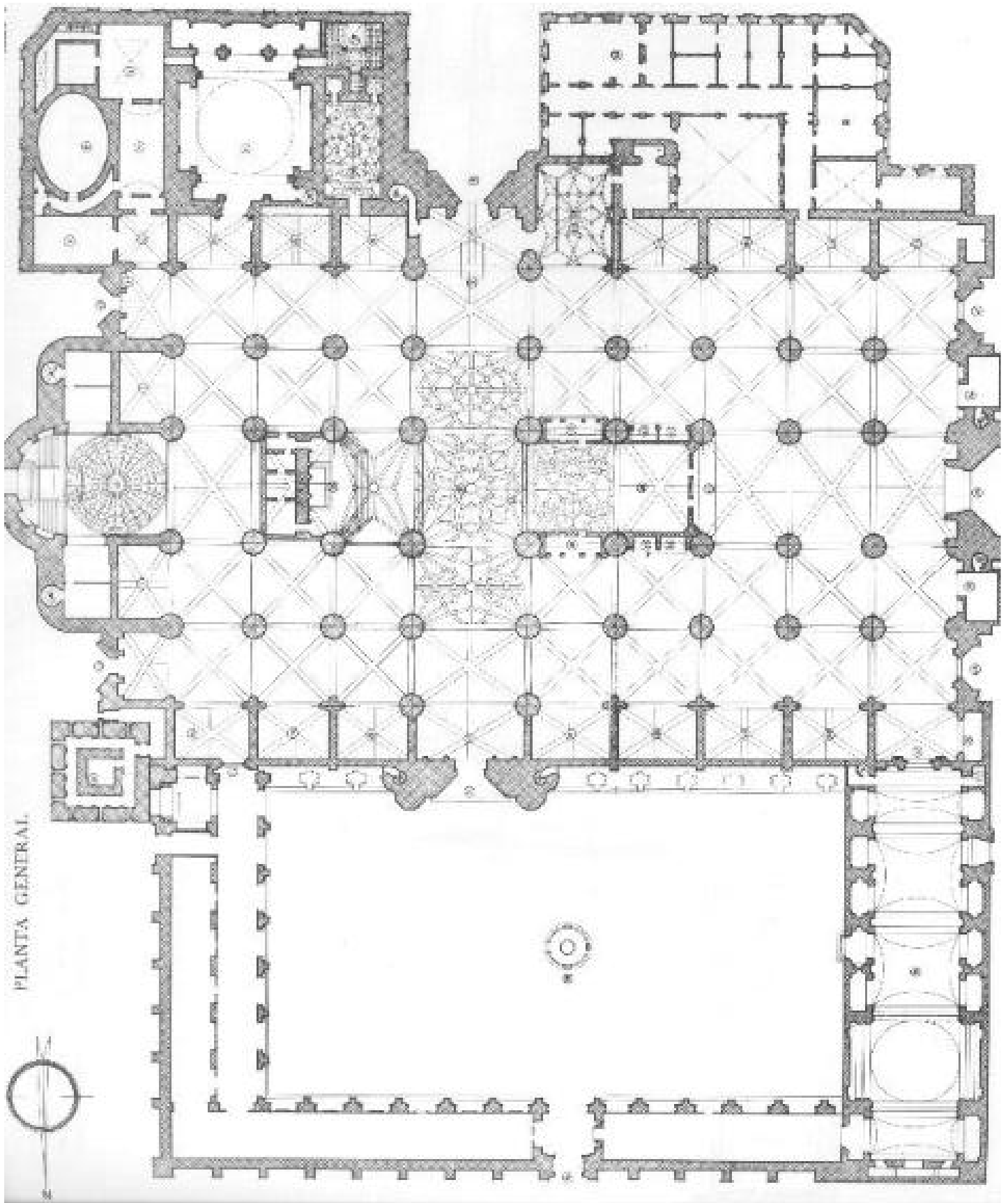

Fig. 105  
Mixtilíneo.

Sevilla





PLANTA GENERAL.

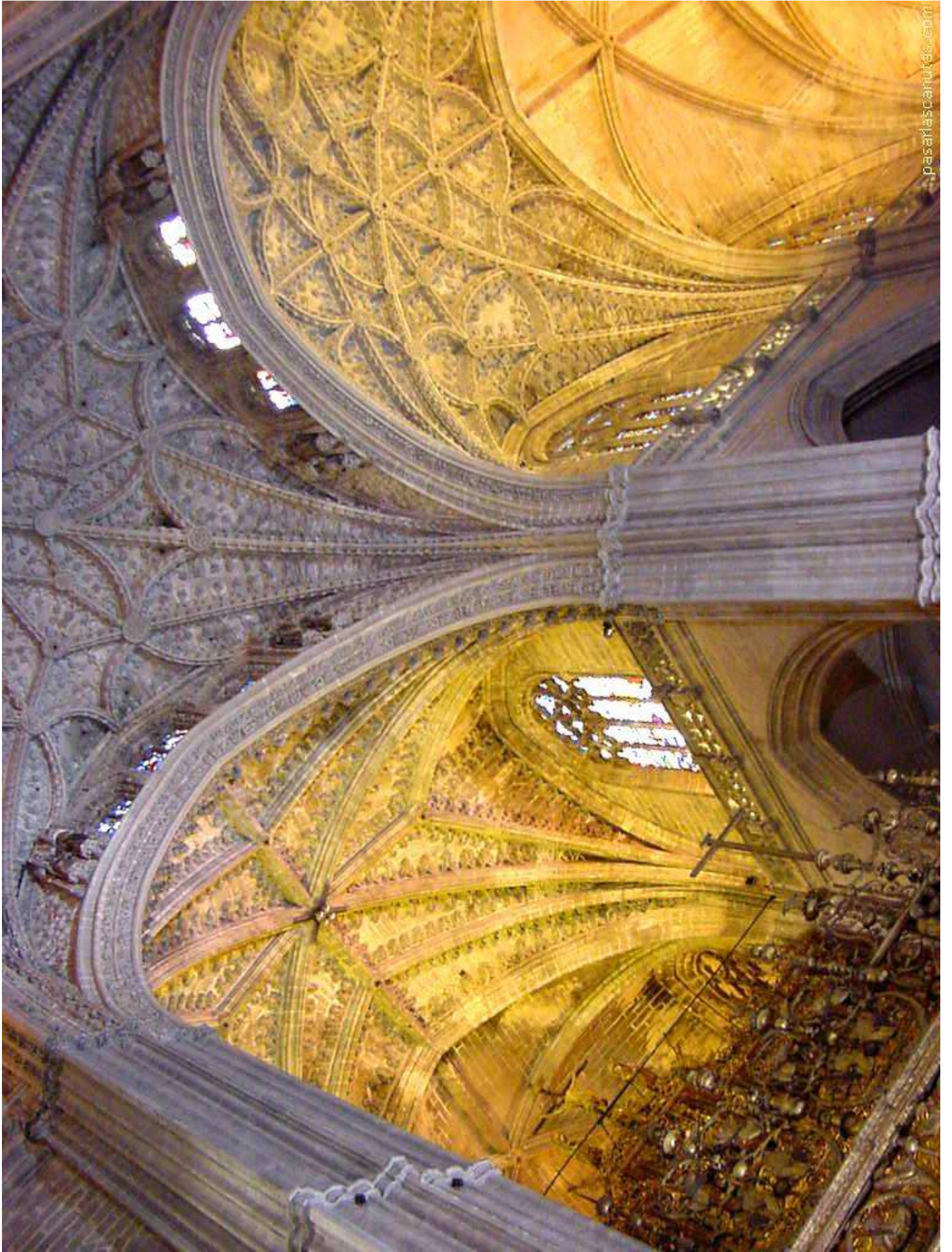

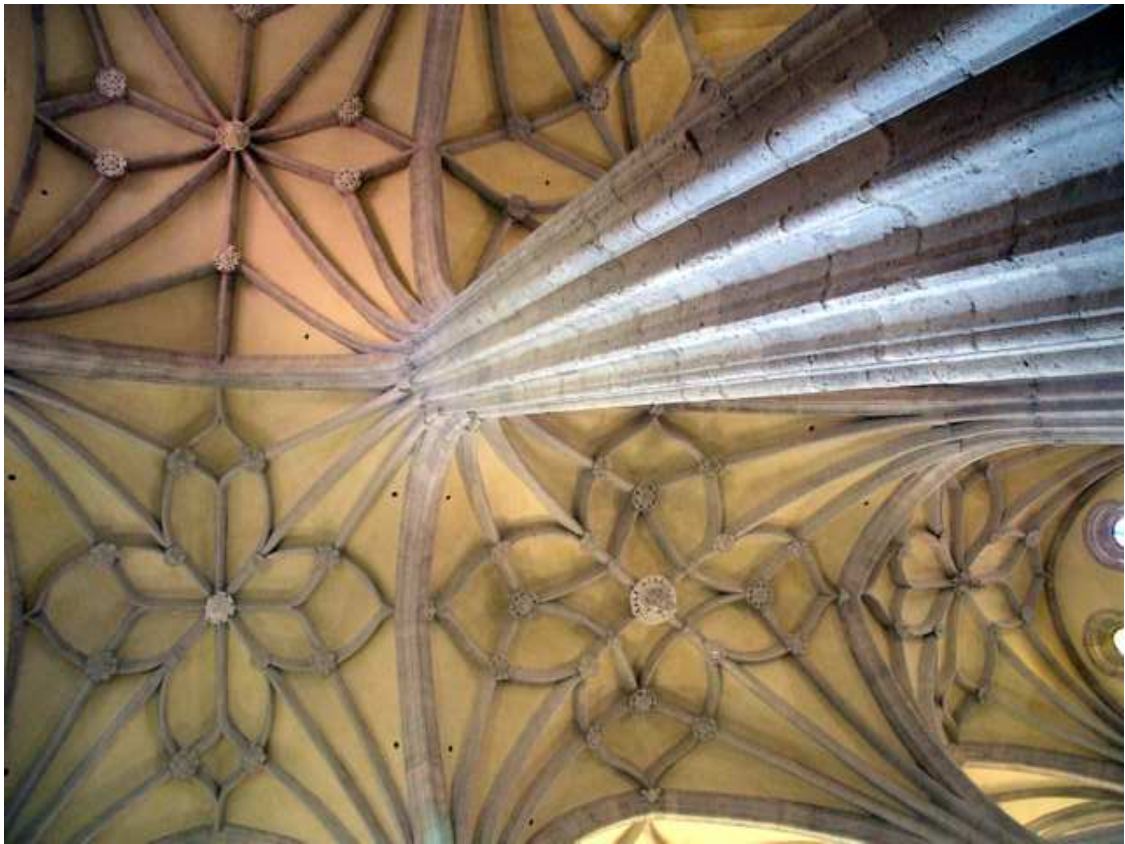

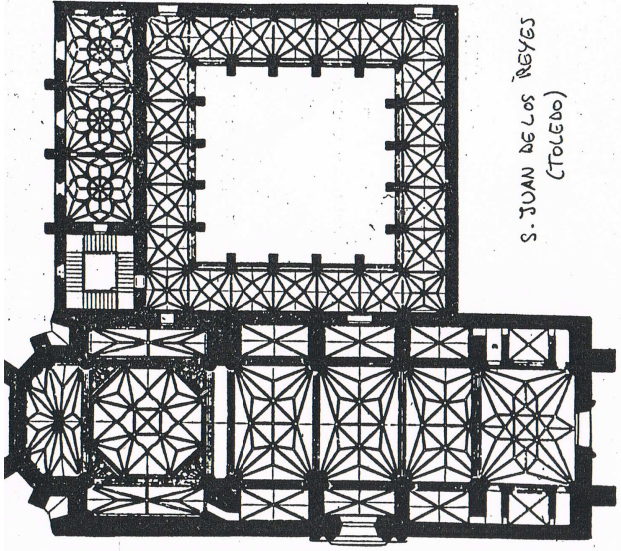

S. JUAN DE LOS REYES  
(Toledo)

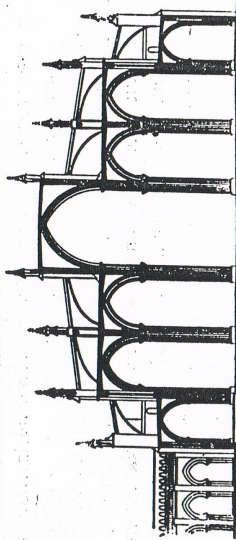

a) CAT. SEVILLA

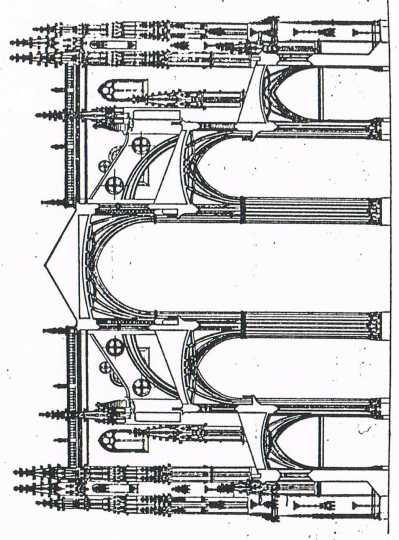

b) CAT. NUEVA SALAMANCA



S. JUAN DE LOS REYES: Juan Guas y Enrique Egas





© arteguias.com

# SIMÓN DE COLONIA: AGUJAS DE LA CATEDRAL



SIMÓN DE COLONIA:  
capilla del  
Condestable



S. GREGORIO



S. PABLO



Pal. Pedro I Tordesillas



# **ESCULTURA**



Pellejería-Burgos

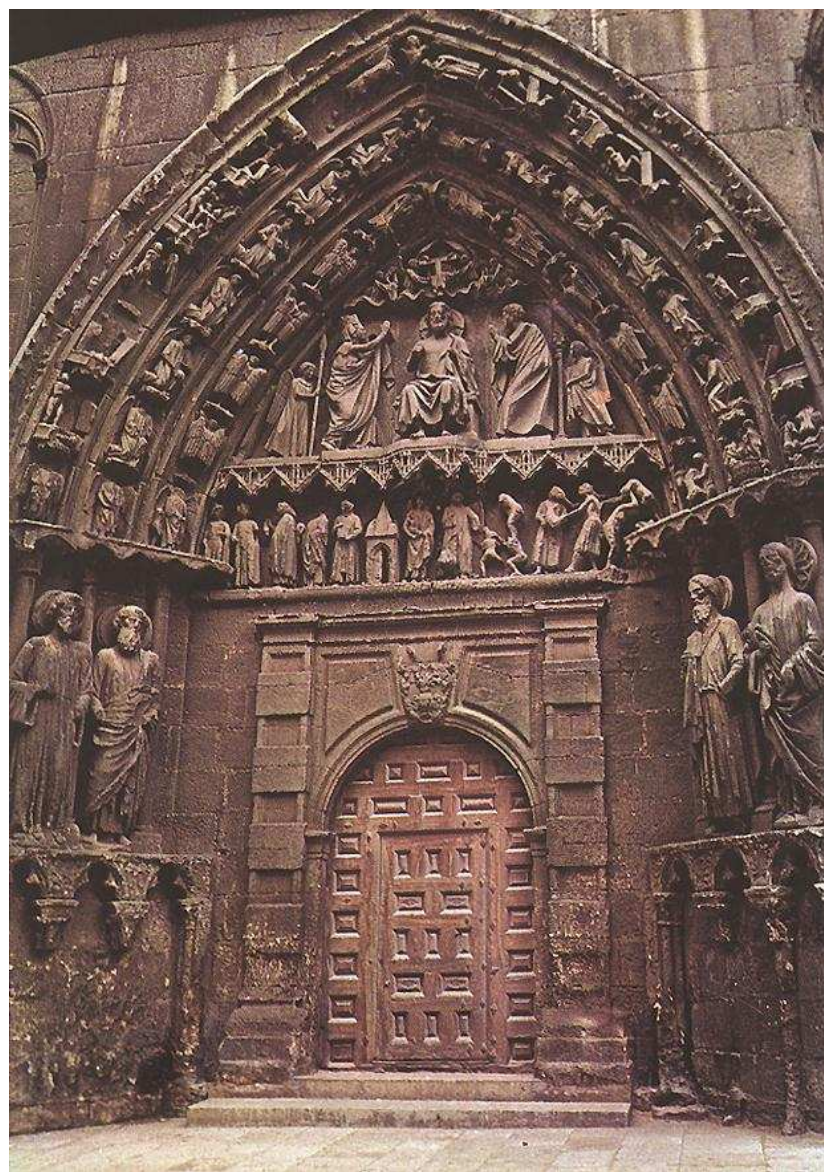

SARMENTAL-BURGOS



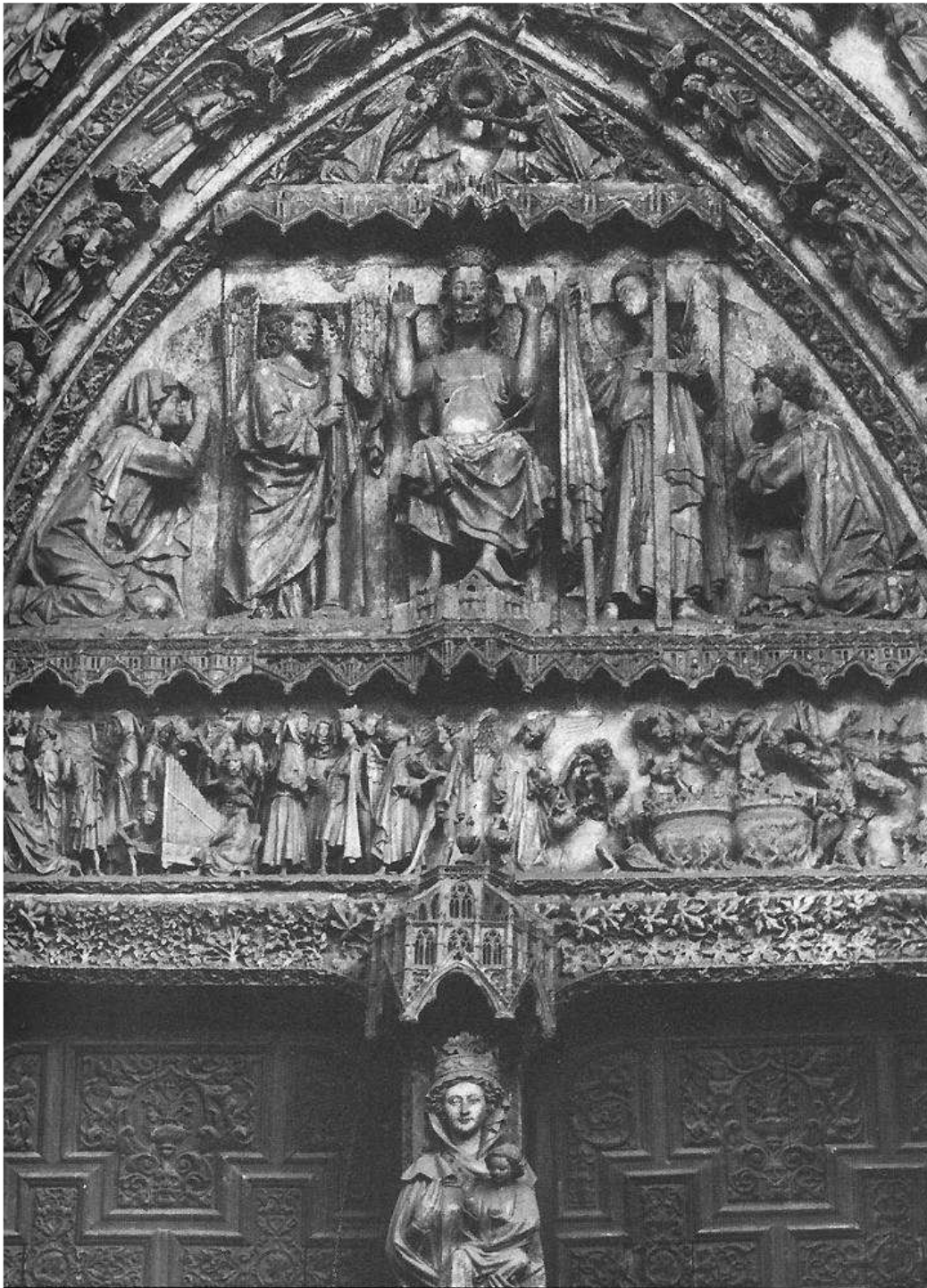

León



VIRGEN GÓTICA  
N<sup>a</sup> S<sup>a</sup> LA BLANCA,  
TOLEDO



# CALVARIO Y PIEDAD



Cartuja Miraflores: GIL DE SILOÉ









Cartuja Miraflores:  
JUAN II Y LA REINA  
ISABEL



Tumba Infante Alfonso-Siloé (CARTUJA)



S. PABLO



# S. GREGORIO

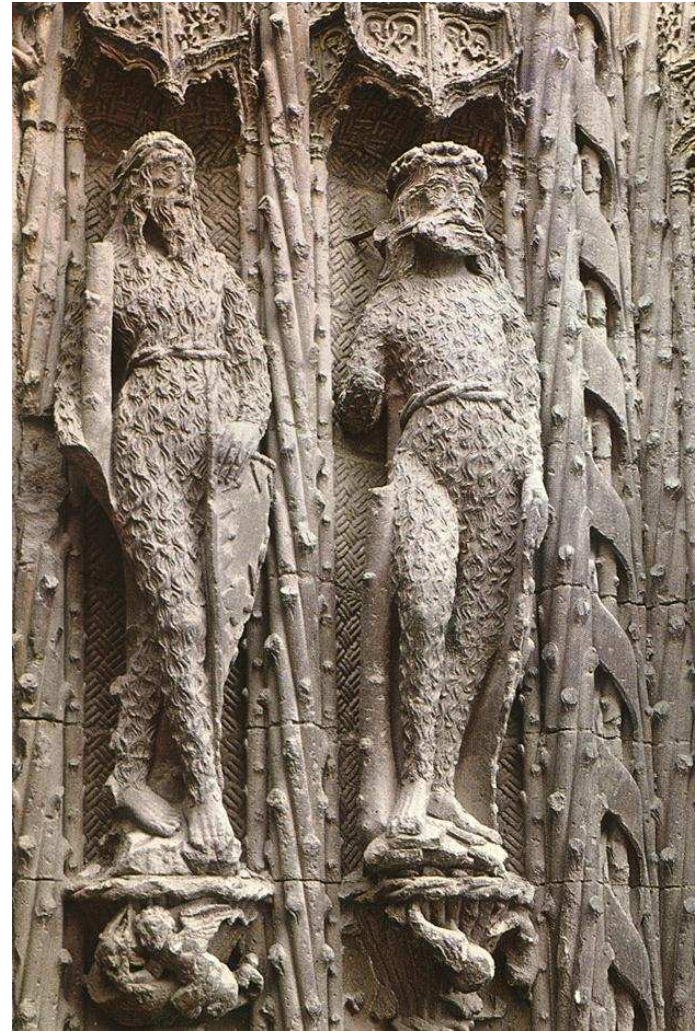
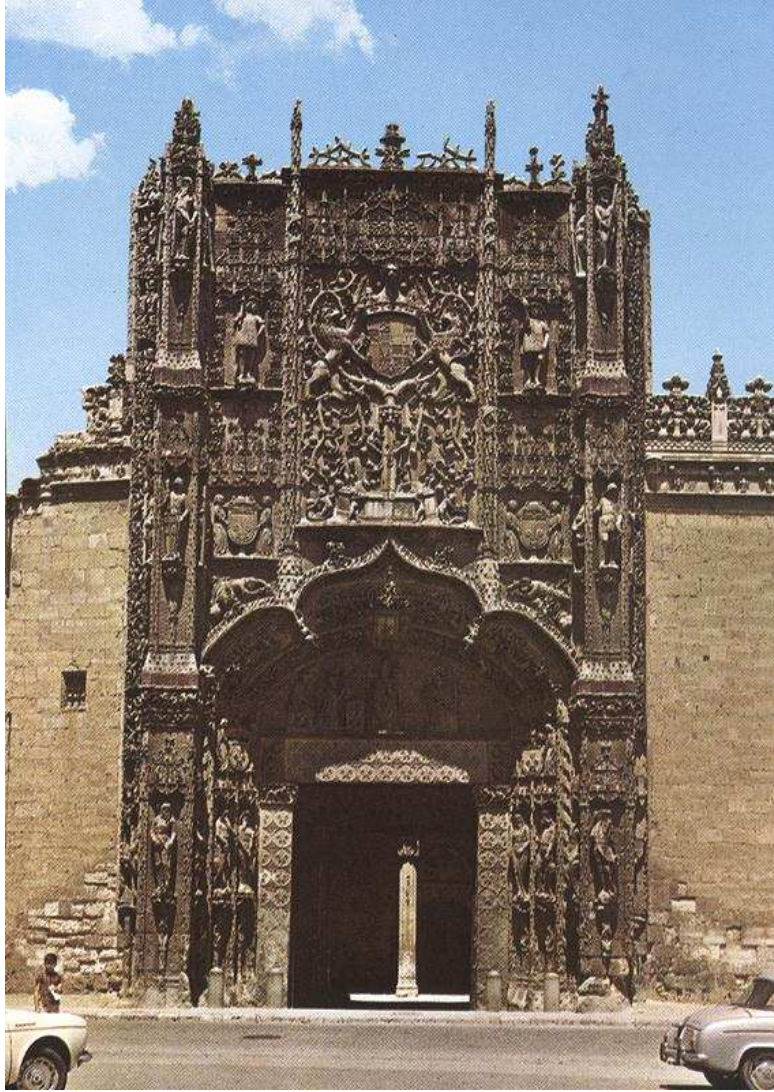





# Cantigas

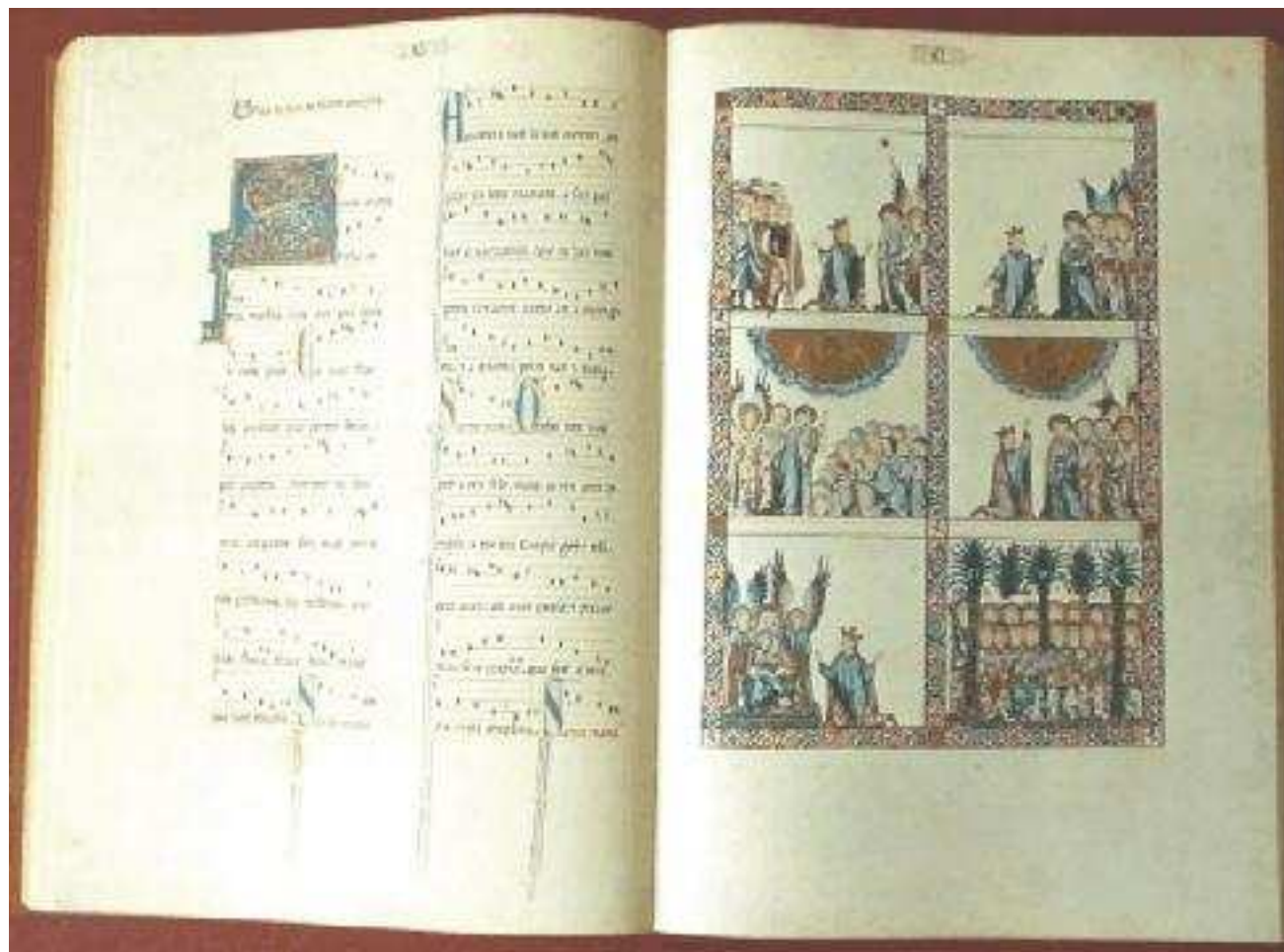

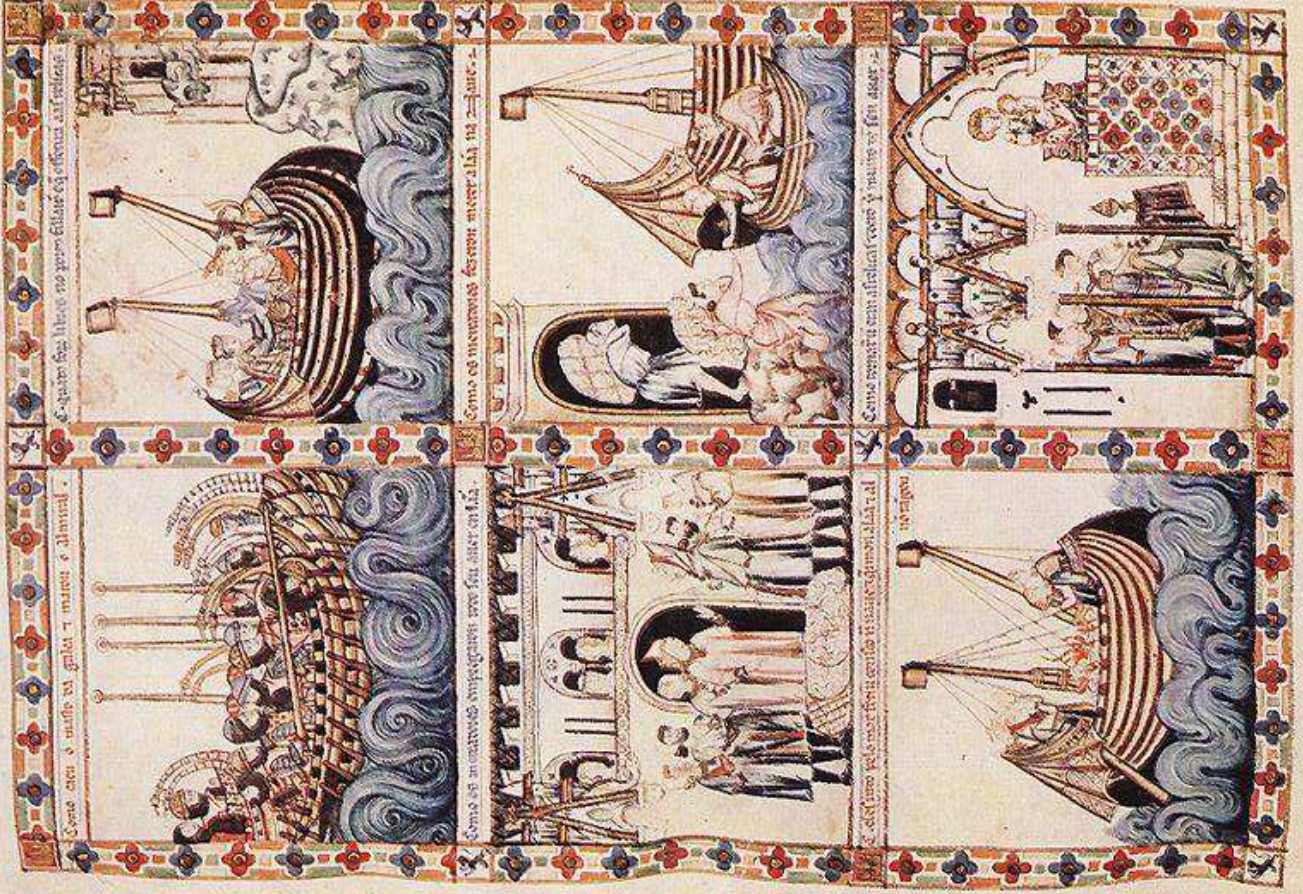



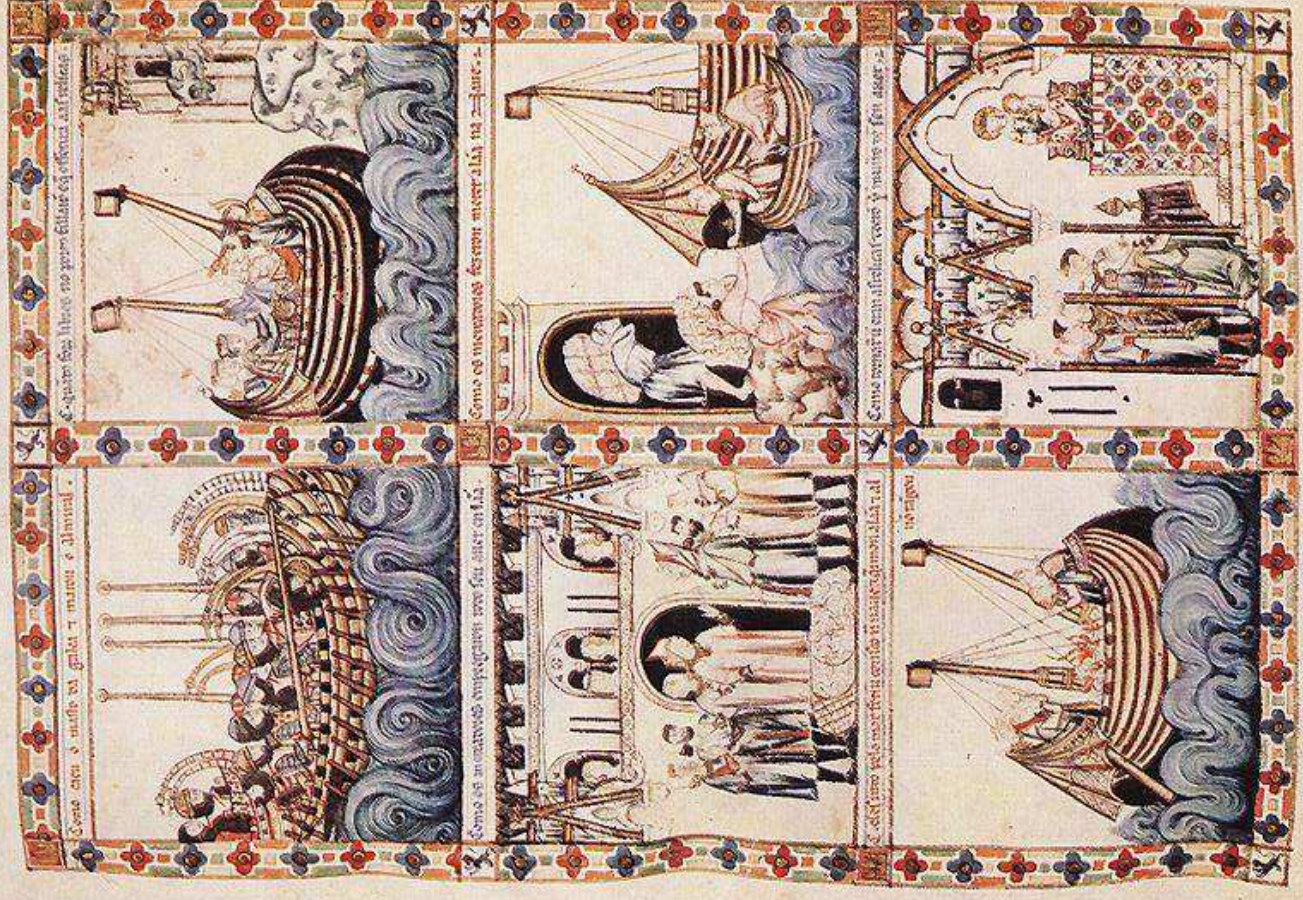

Dalmau-  
VIRGEN DELS  
CONSELLERS



Huguet



Huguet



Bermejo

