

EVOLUCION DEL ARCO DE HERRADURA

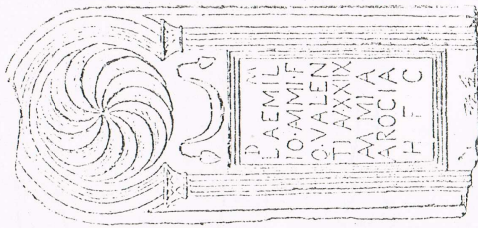

Estela de L. Emilie Valente, de León. (Museo Arq., Madrid).

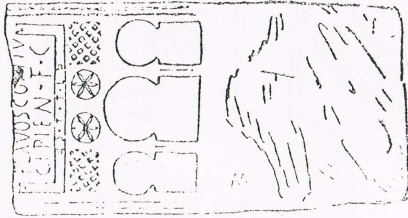

Estela de la mujer de Flavo, proc. de LEON

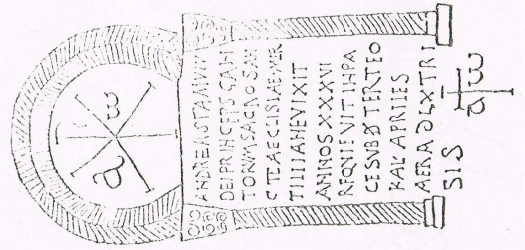

Estela de Andrés

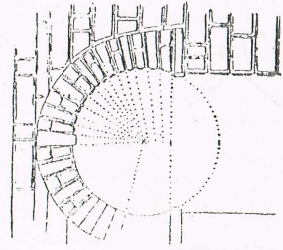

Puerta de Bibalatarin, en Sevilla. Anterior al año 711.

# S. JUAN DE BAÑOS

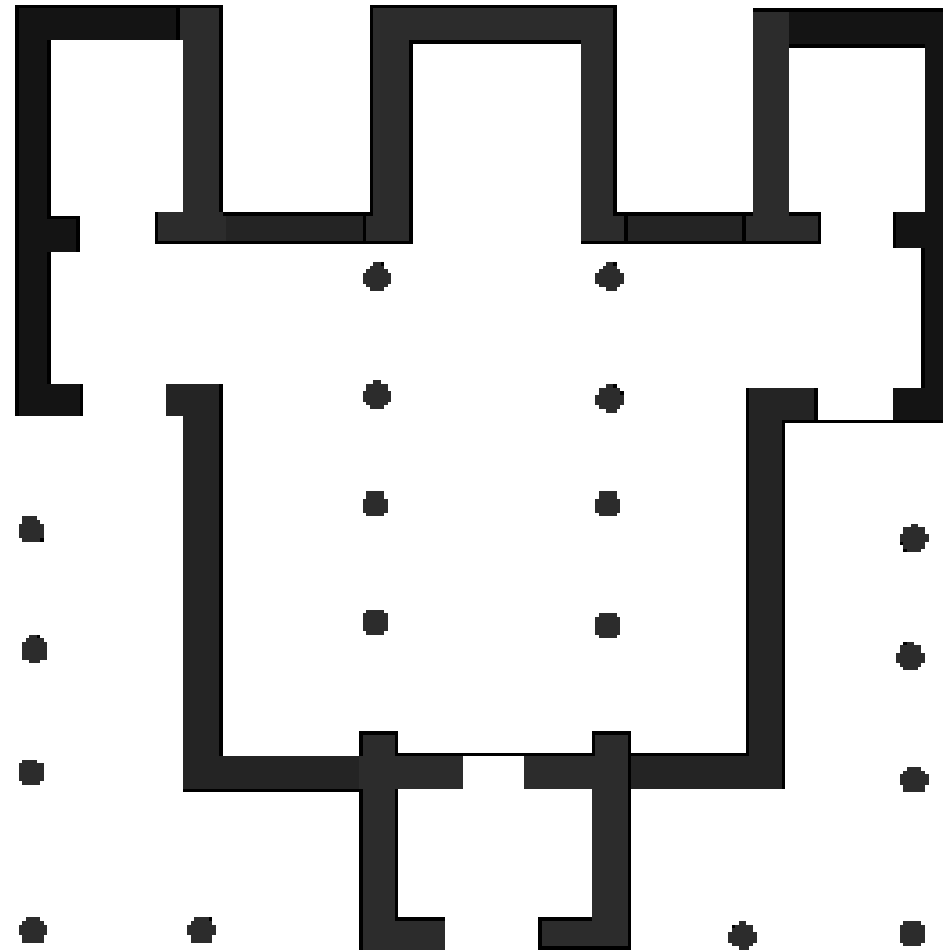











# S. PEDRO DE LA NAVE

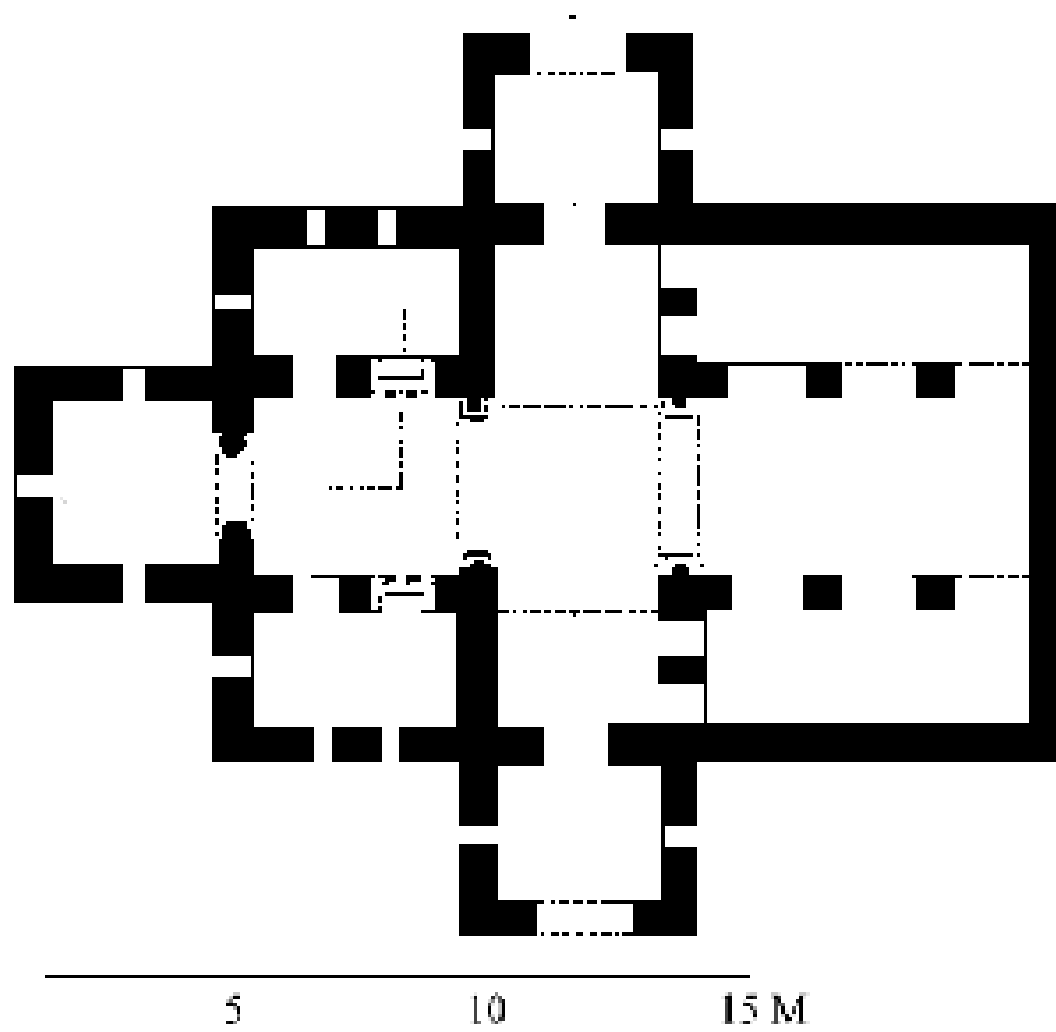















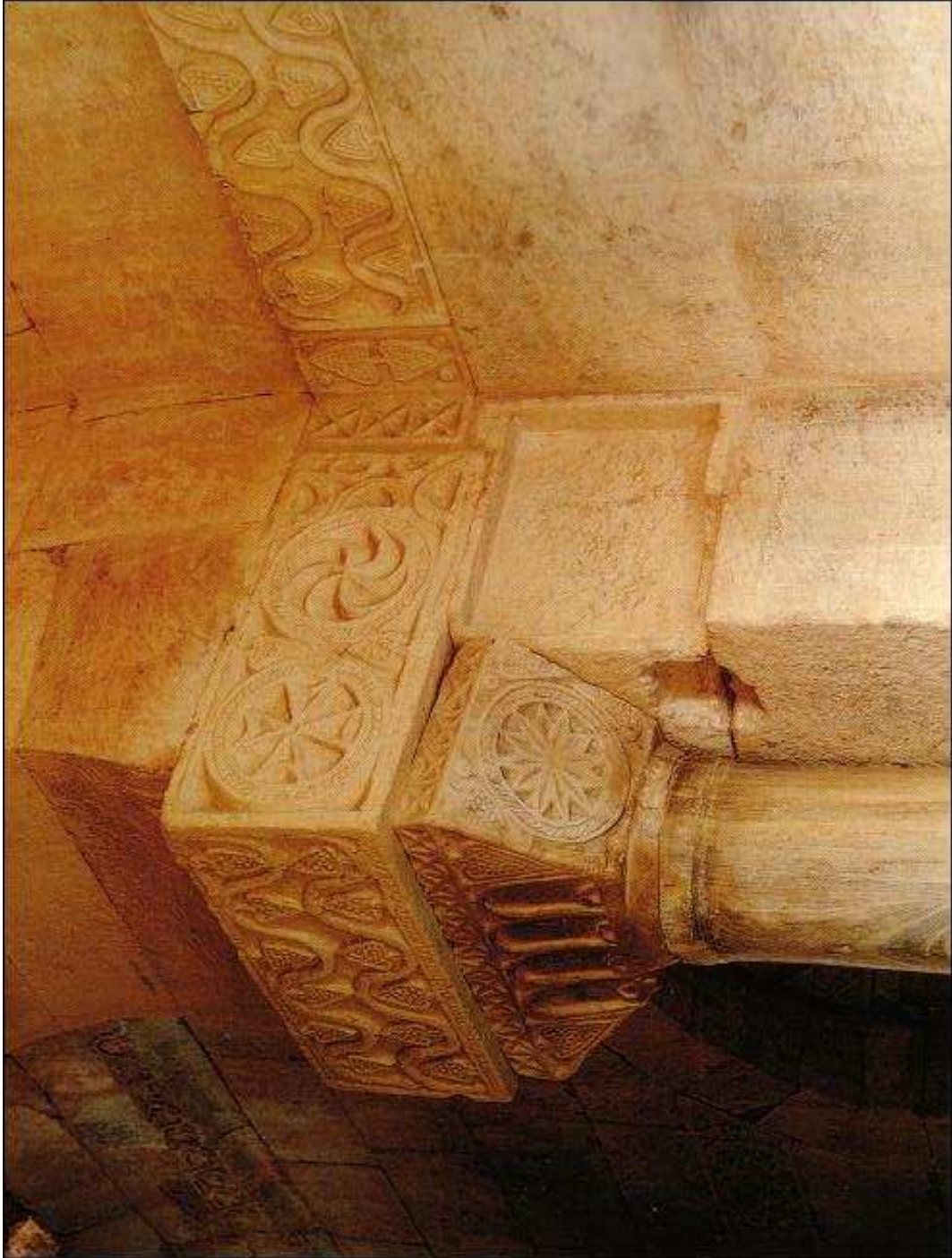





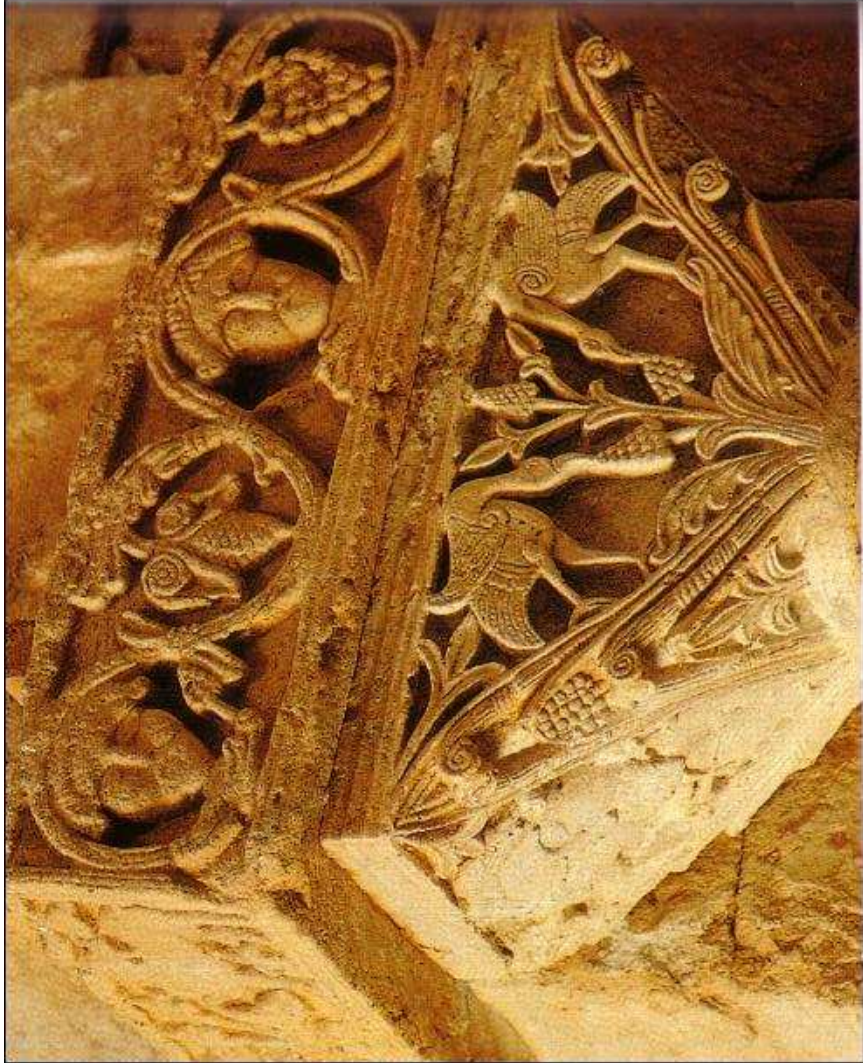

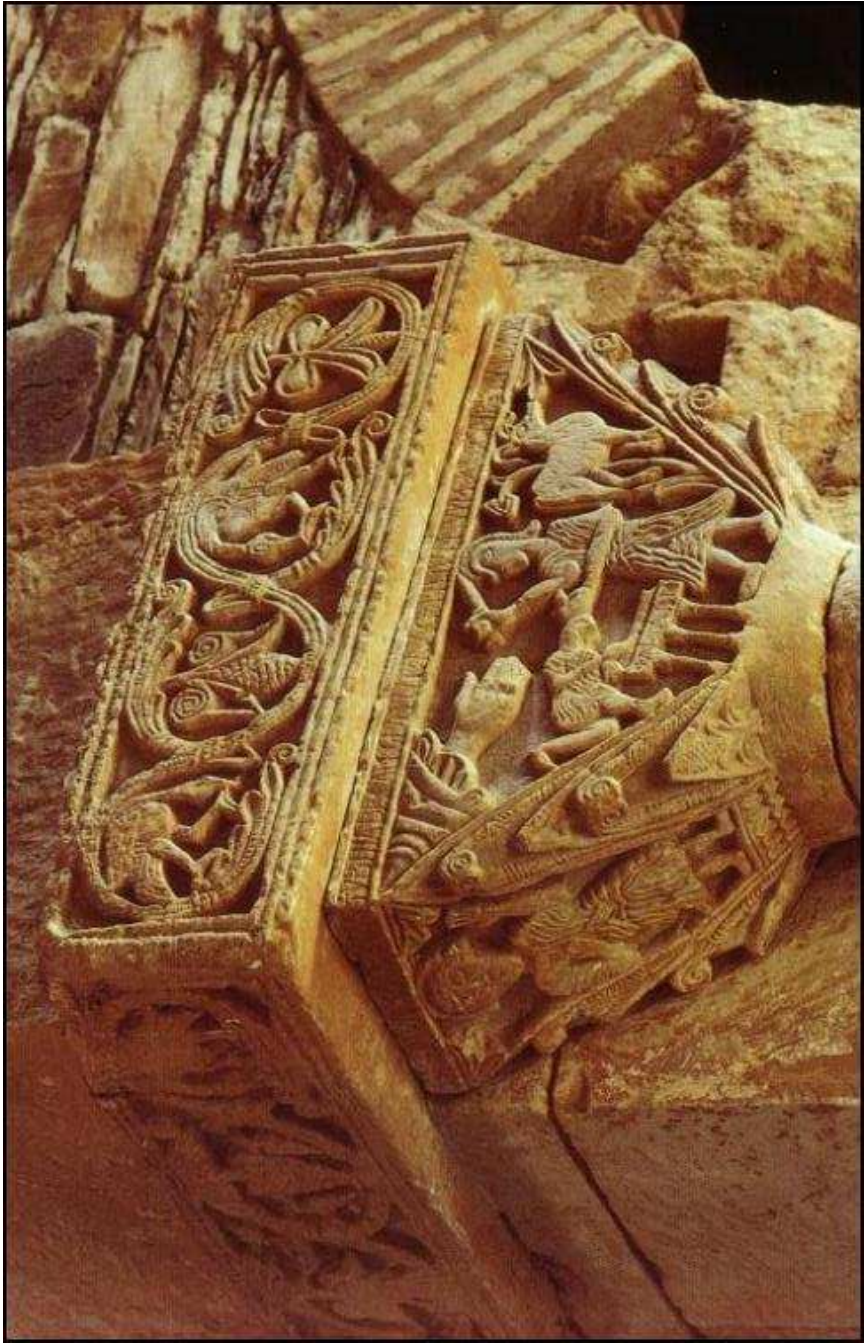

# QUINTANILLA DE LAS VIÑAS





## TESORO DE RECESVINTO

